

Fitting Instructions

| Issue | Date | Changes |
|-------|------------|------------------------------|
| 1 | 16/01/2024 | Fitting Instructions created |



Safety Warning

These Fitting Instructions are for informational purposes only. Shelbourne Reynolds makes no representation or warranty, express or implied, regarding the information provided herein. Under no circumstances will Shelbourne Reynolds have any liability to you for any loss or damage resulting from the use of these instructions or reliance on any information provided. It is extremely dangerous to carry out any work on a machine while it is under power. Never remove or reattach any parts unless the machine is fully turned off and disengaged.

Please read all safety instructions contained in your operators manual and observe all safety signs attached to the Stripper header. Your use of these instructions is solely at your own risk.

Please use proper safety equipment at all times.



Refer to the Operators Manual for additional information and Safety procedures.

These instructions are worded if the kit was being installed while the header is mounted on a combine, to have the stripping rotor set in the fastest position and implement the safe stop procedure.

If not the pulley drive and actuator may need rotating and cycling to assist.

Recommended Tools List

13mm Socket + Extension
17mm Socket
19mm Socket
24mm Socket (for ½" Impact)
30mm socket (for ½" Impact)
3mm Allen Key

13mm Wrench
19mm Wrench
2 x 30mm Wrenches
M10 x 1.5 Tap
Hydraulic Press (Optional)
Anti-Seize / Copper slip

Block Of Wood
Large Mallet
Tie Wraps
2 Medium Pry Bars
Large Pry Bar
ThreadLocker

All the information in these Fitting Instructions is also contained in a video, scan the QR code to access.



1. Run the machine until rotor pulley is fully open, rotor speed at maximum.



Stop the machine and implement the safe stop.

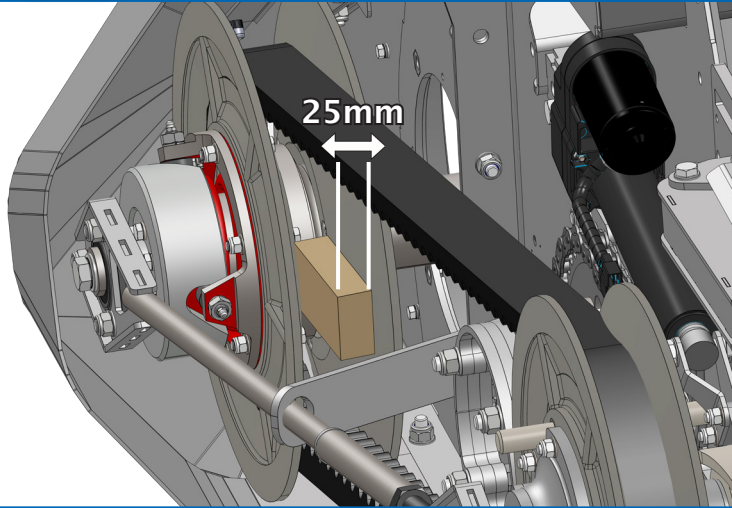

Open the drive guard and wedge pulley's open.



DO NOT put hands between pulley sheaves.

2. Remove the guard.

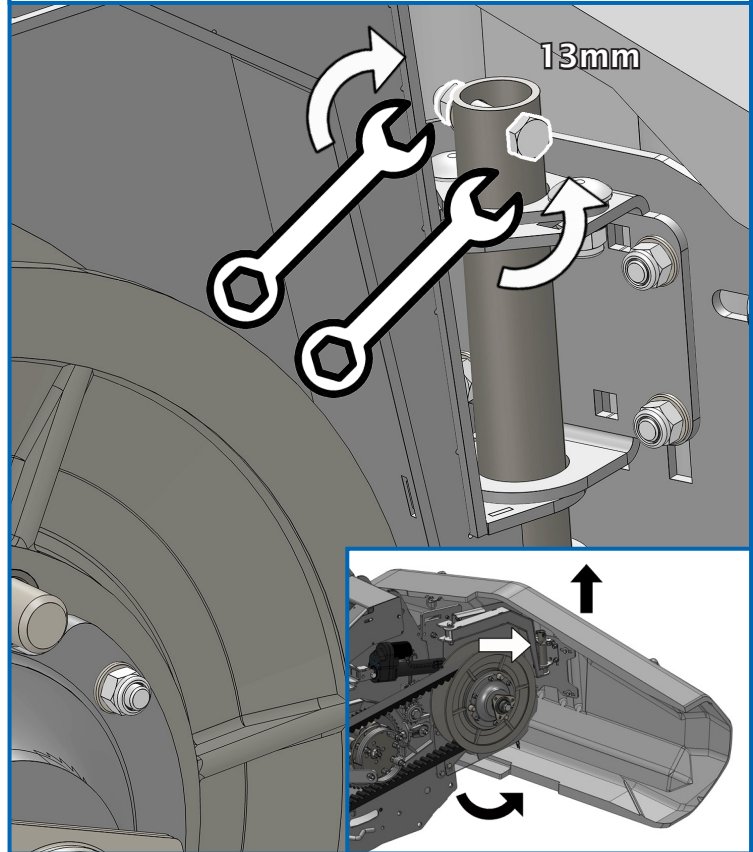

3. Loosen the tie rod.

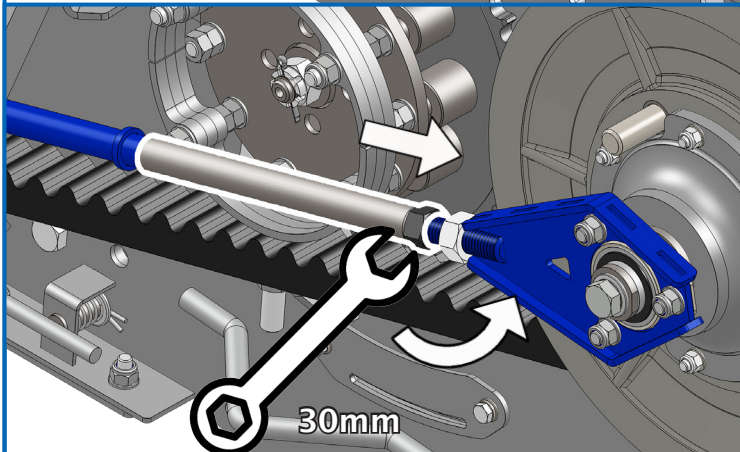
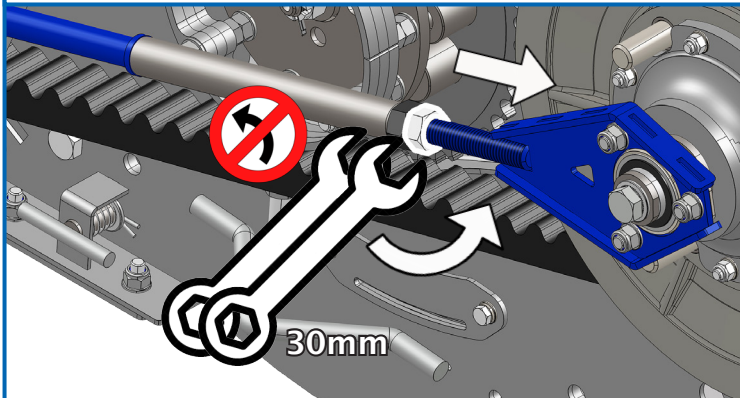

4. Loosen the tie rod support fasteners.

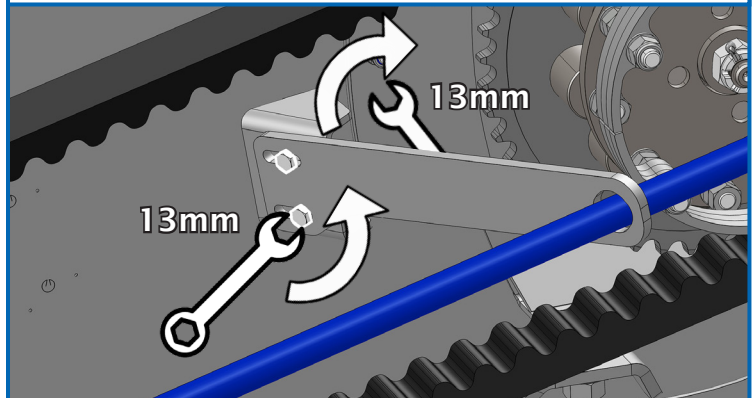

Move up and down to ensure no binding on the tie rod or remove completely.

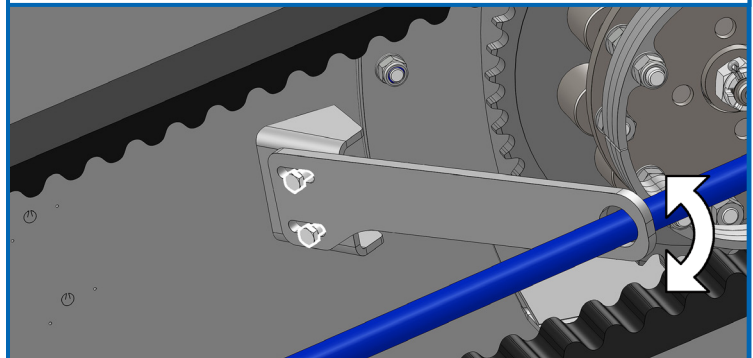

5. Loosen tie rod bearing grub screws (x2).

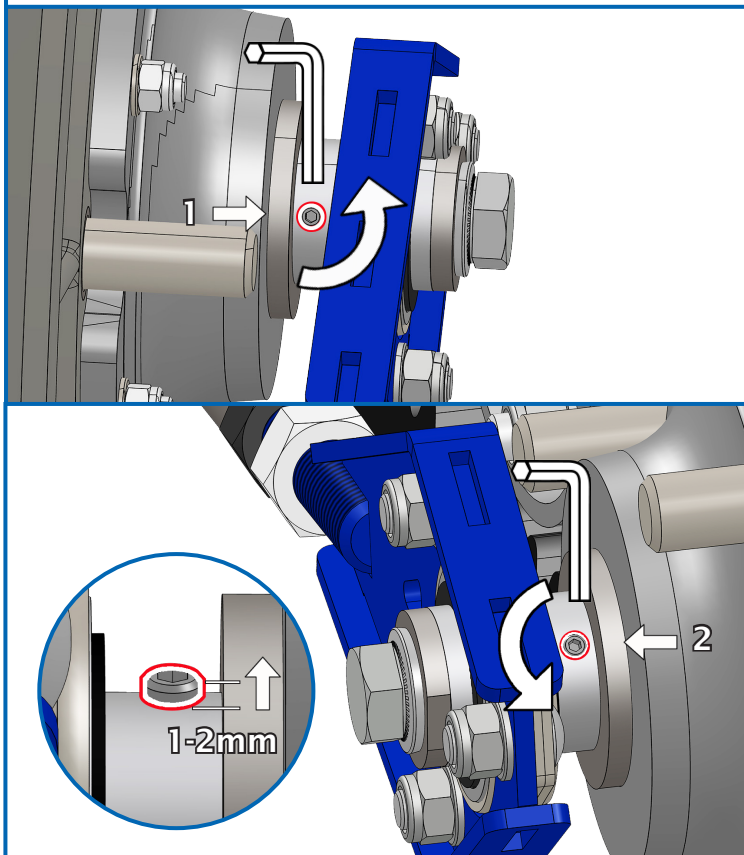

6. Loosen tie rod bearing fasteners on both front and rear pulleys.

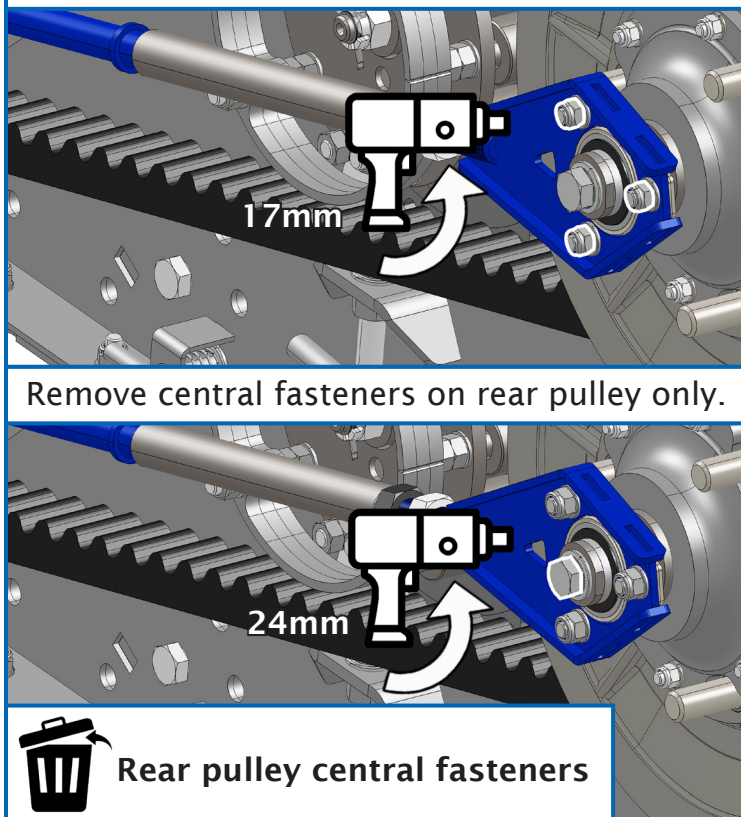

7. Remove the tie rod.

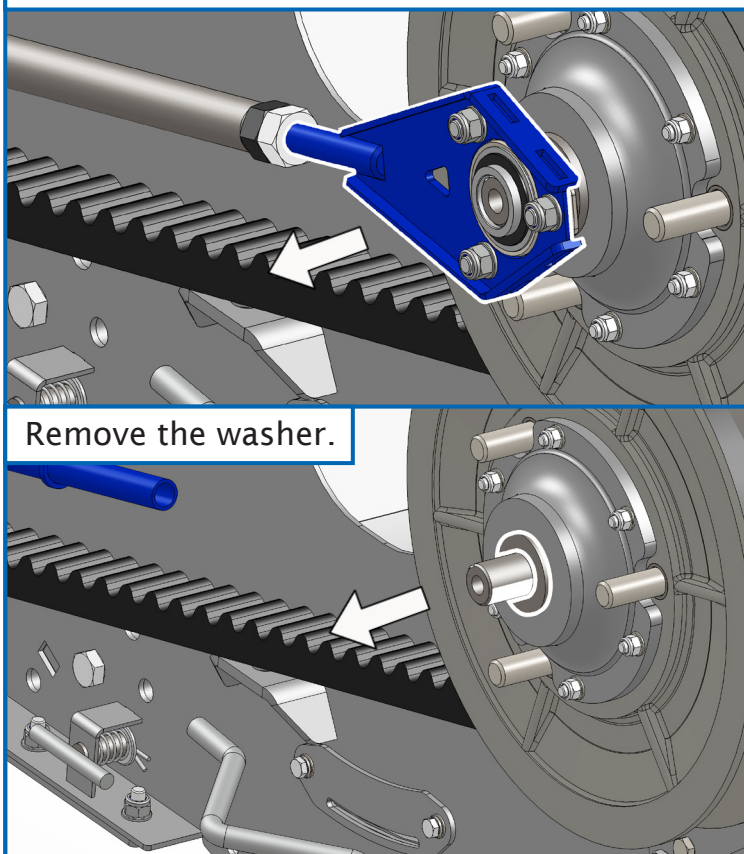

8. Electrically close the actuator fully.

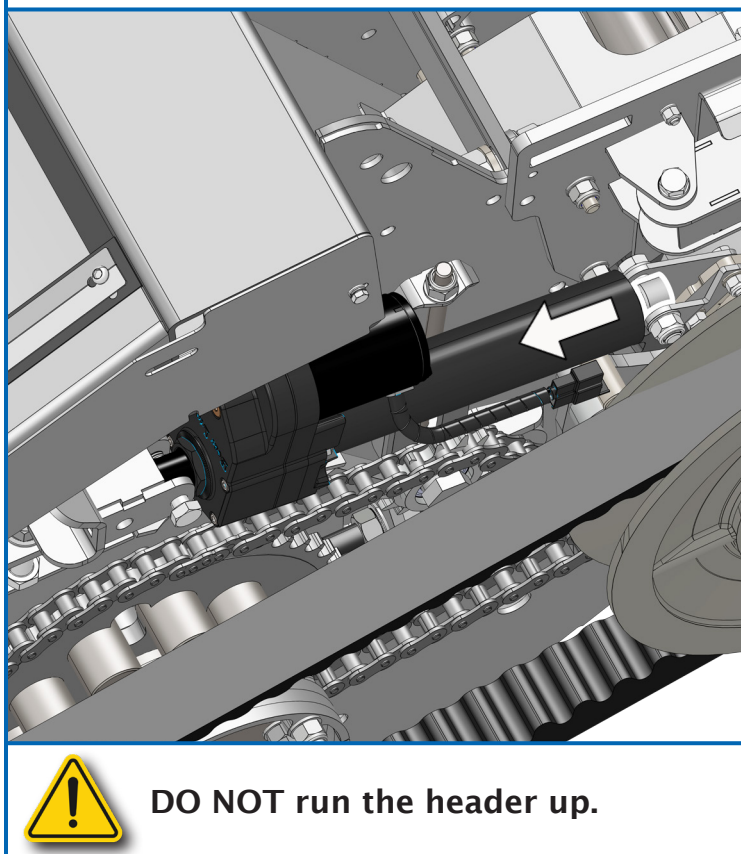

9. Remove pulley assembly.

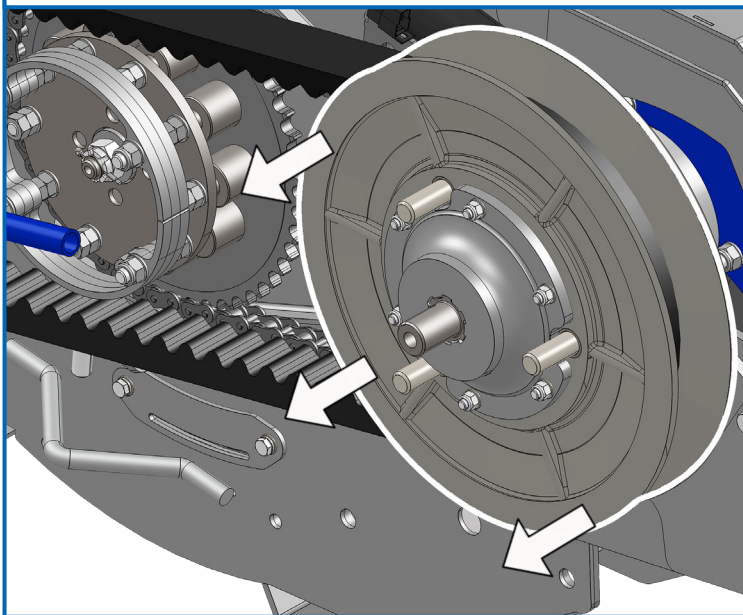

Old pulley assembly.



Take care when removing the pulleys from the shafts, as they weigh 40KG (88lbs).

10. Remove the cam brackets to cam fasteners.

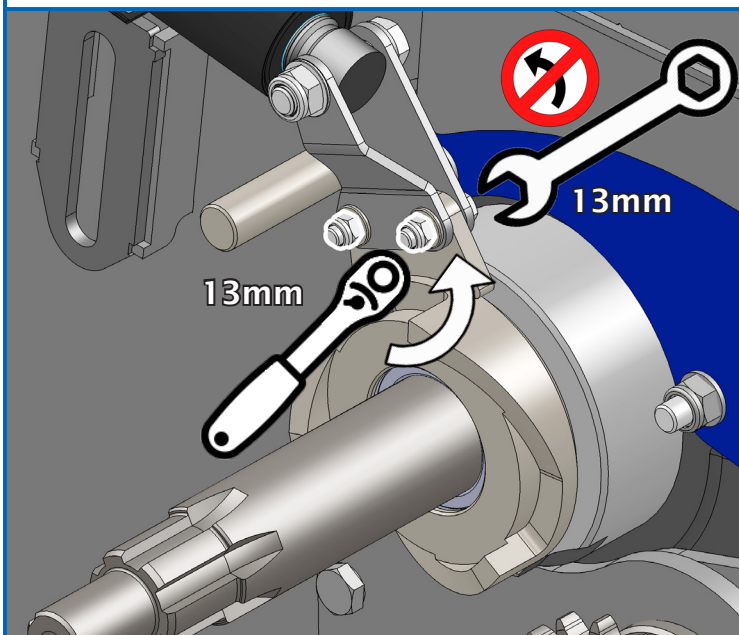

Pivot up the actuator and cable tie out of the way.



Cam fasteners.

11. Pry off the cam and bearing.

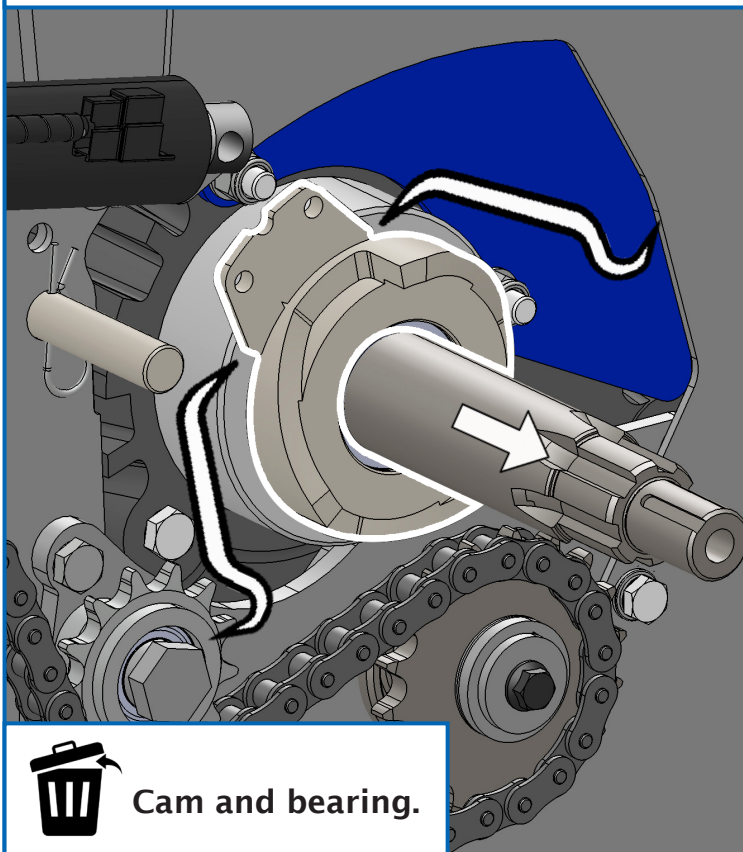

Cam and bearing.

12. Remove the actuator fastener holding on the old brackets and discard. Replace with new brackets.

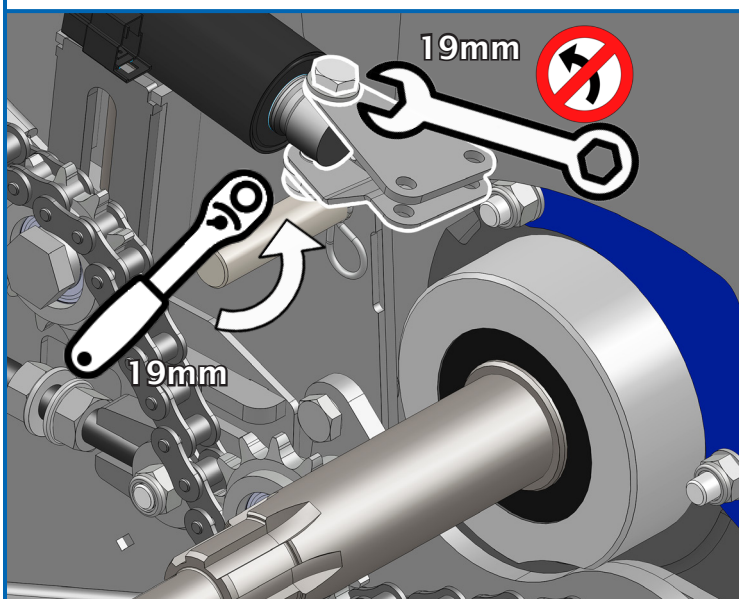

Twist the actuator rod to facilitate removing the bolt.



Actuator brackets and fastener.

13. Slide on the new cam assembly.

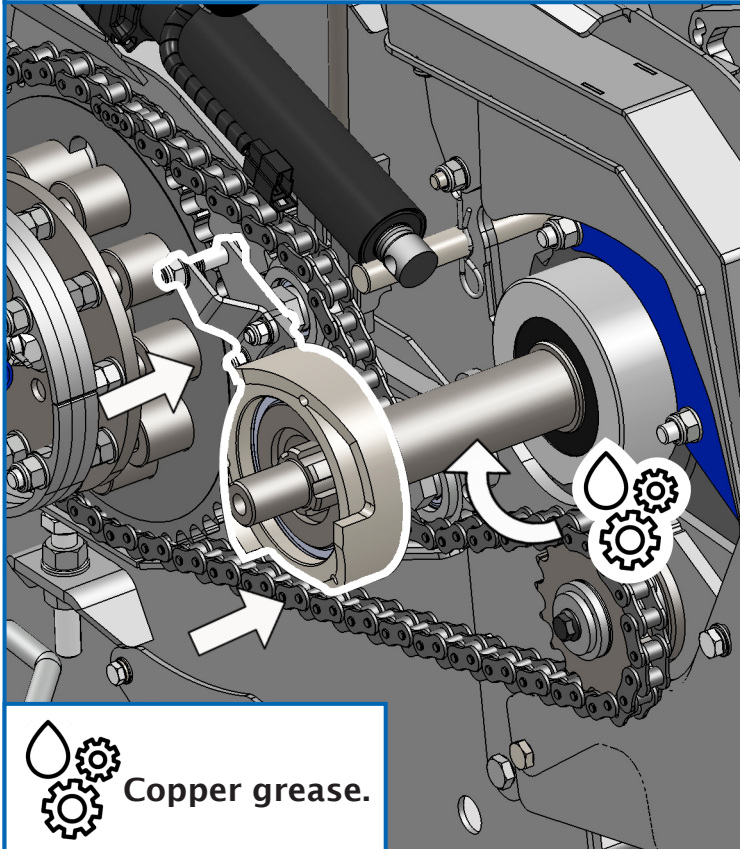

14. Separate the new pulley sheaves.

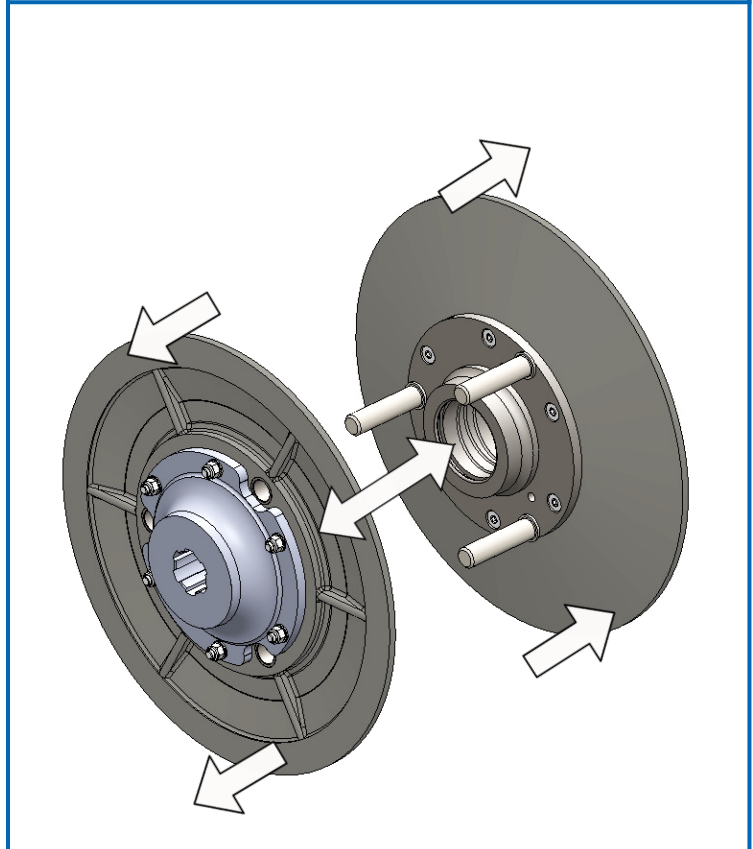

15. Temporarily fit the outer pulley half on the gearbox shaft.

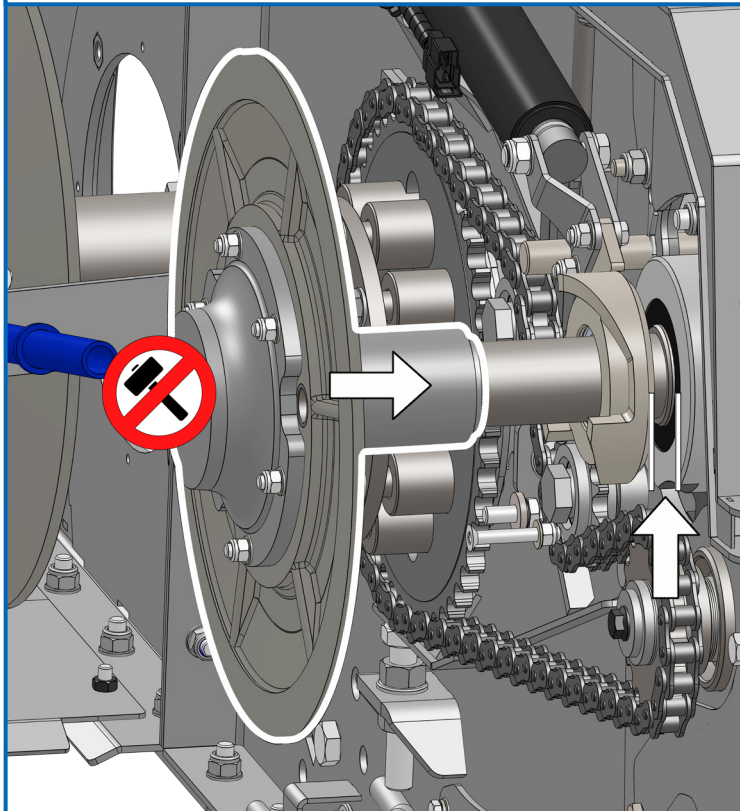

16. Use to push the cam fully home.

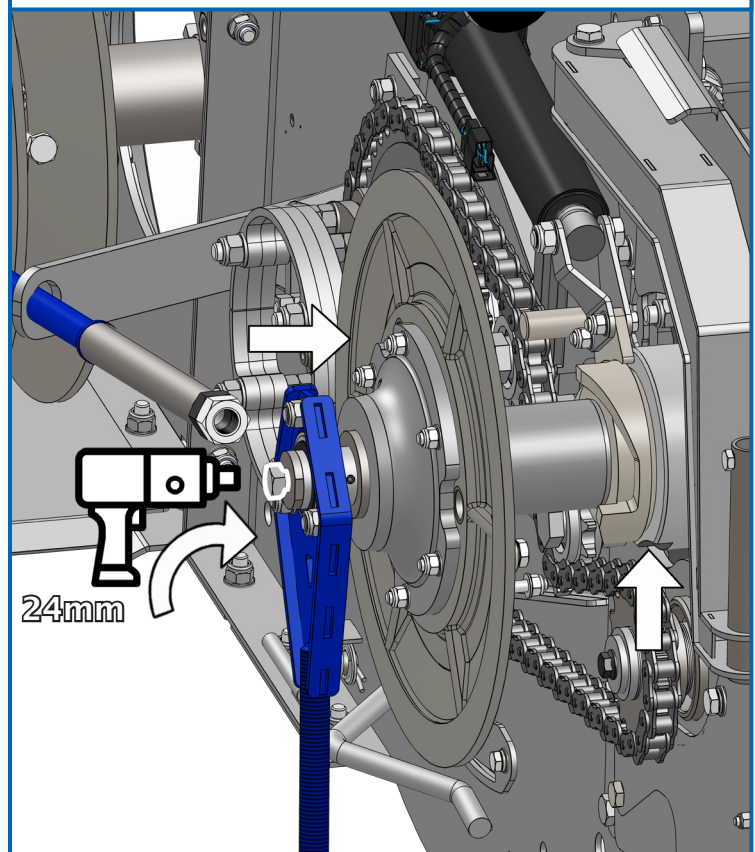

17. Remove the outer pulley half afterwards.

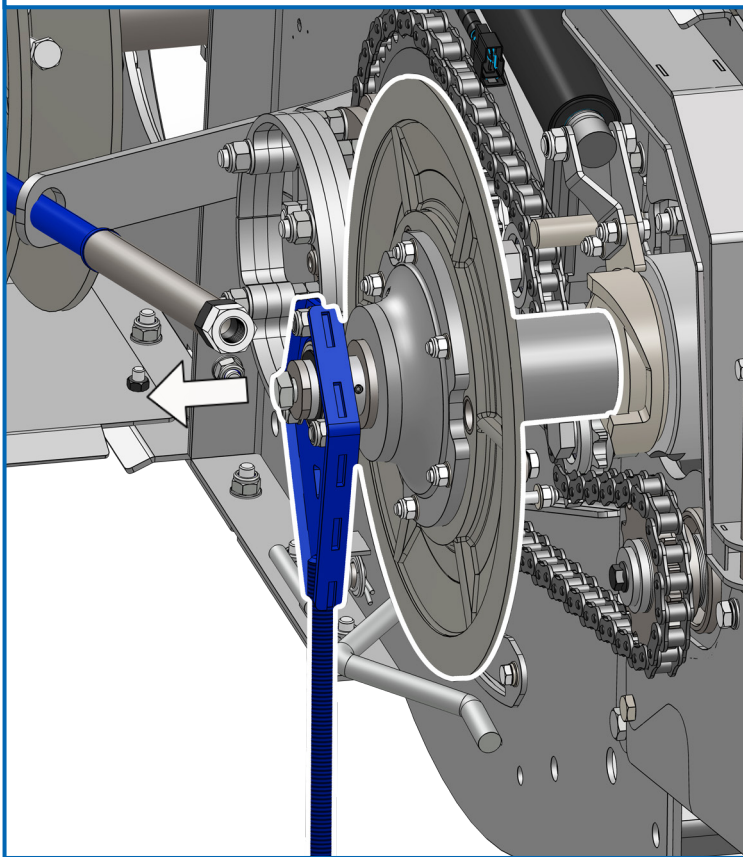

18. Remove the cable tie from the actuator and refit the cam bracket fasteners.

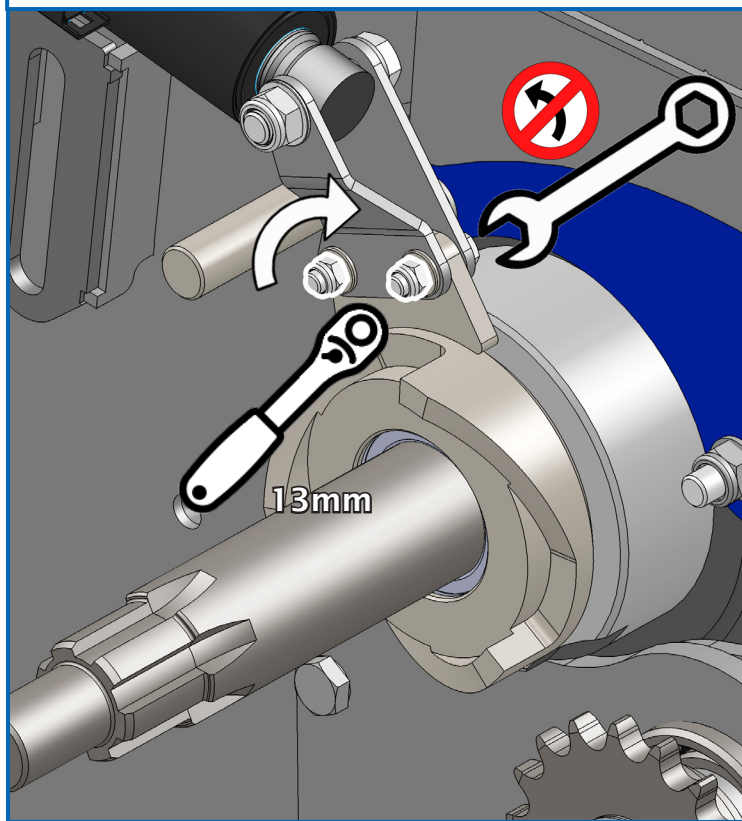

19. Reassemble the new pulley sheave, then grease the pulley assembly.

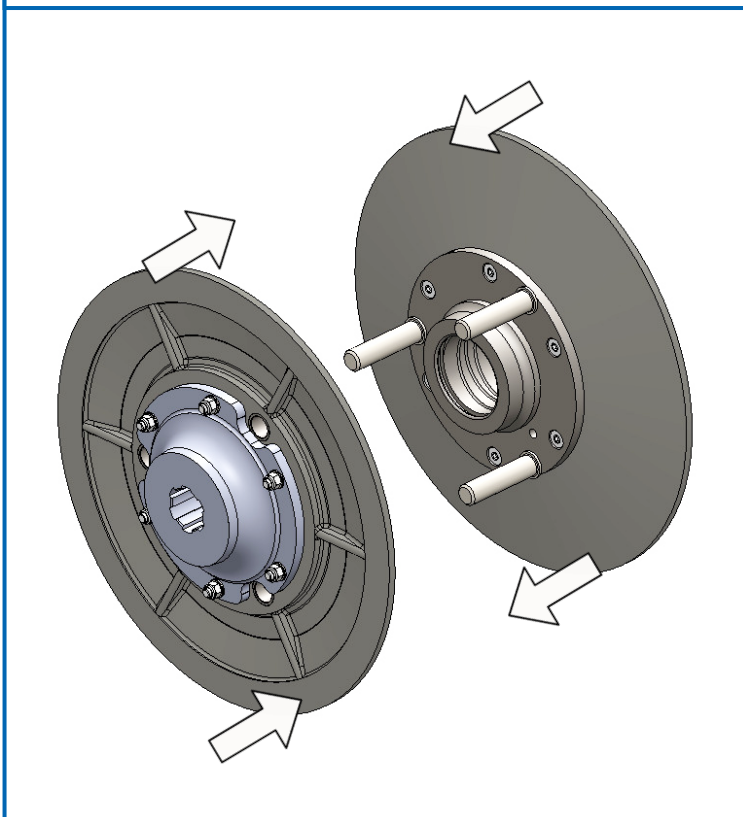

20. Slide the new pulley assembly with the belt inside on to the shaft.

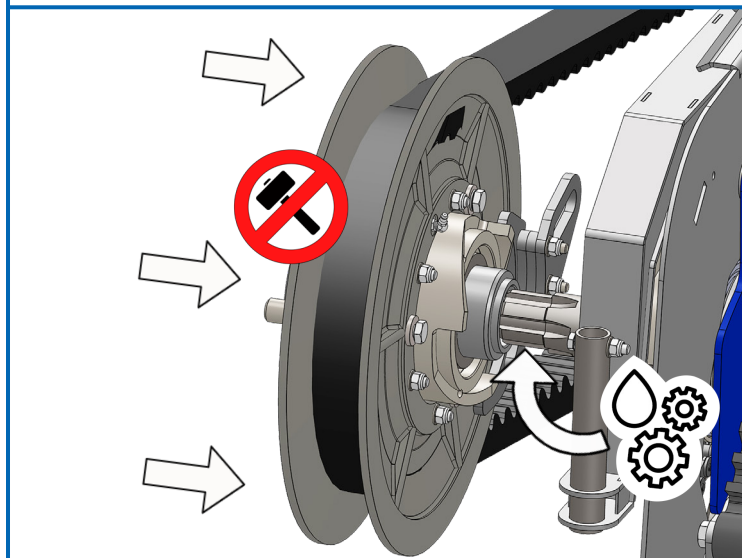

Molybdenum grease (black grease).



Take care when fitting the pulleys, as they weigh 40KG (88lbs).

21. Align the cam plate with the retaining bar.

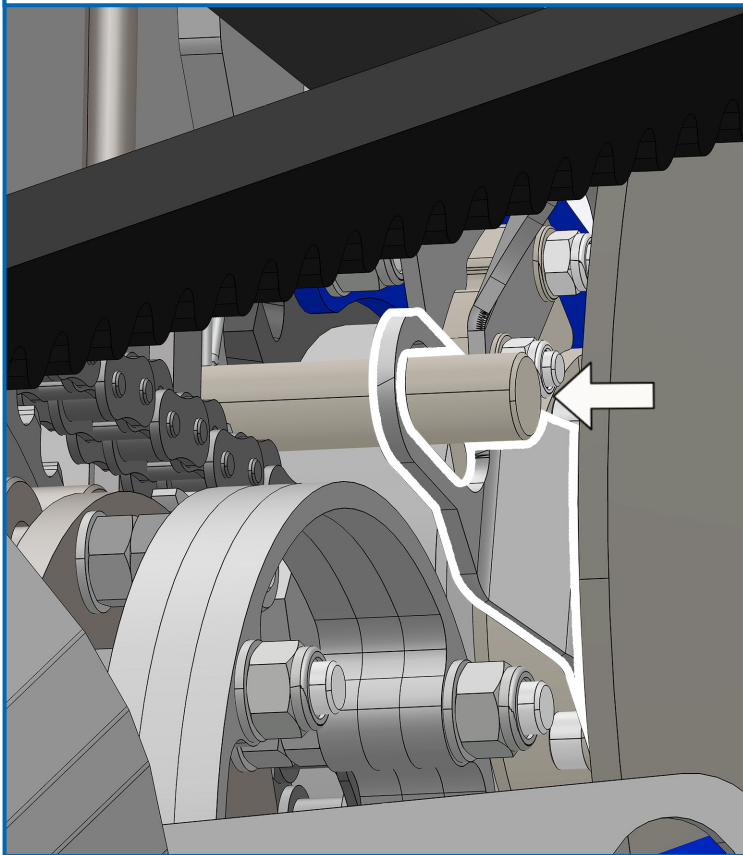

22. Push the new pulley assembly fully home.

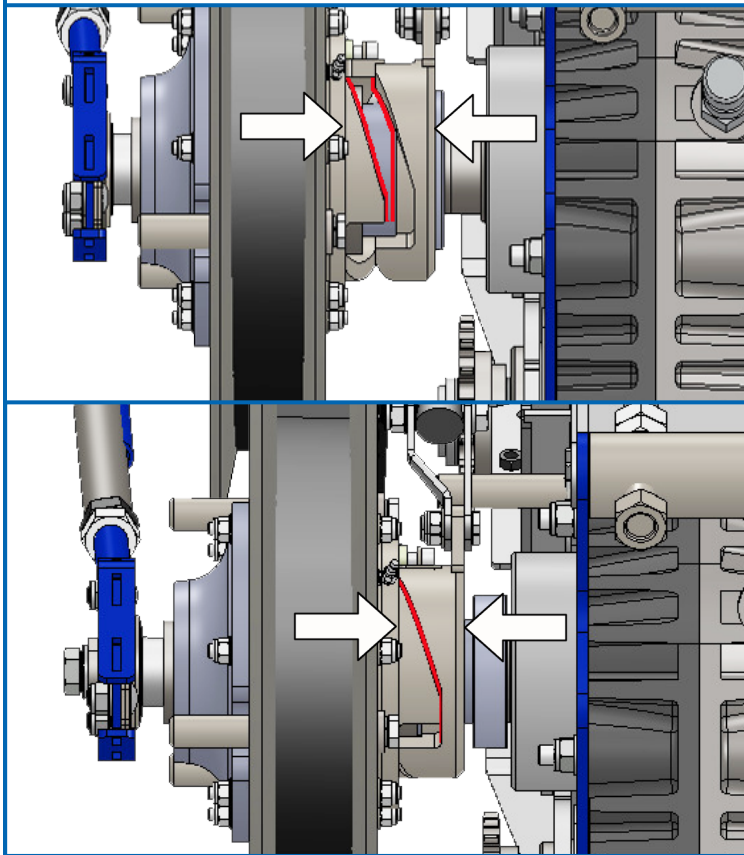

23. Check the belt moves freely between the fully open pulleys and isn't trapped or pinched. Check the dimension between the pulley sheaves is 86mm.

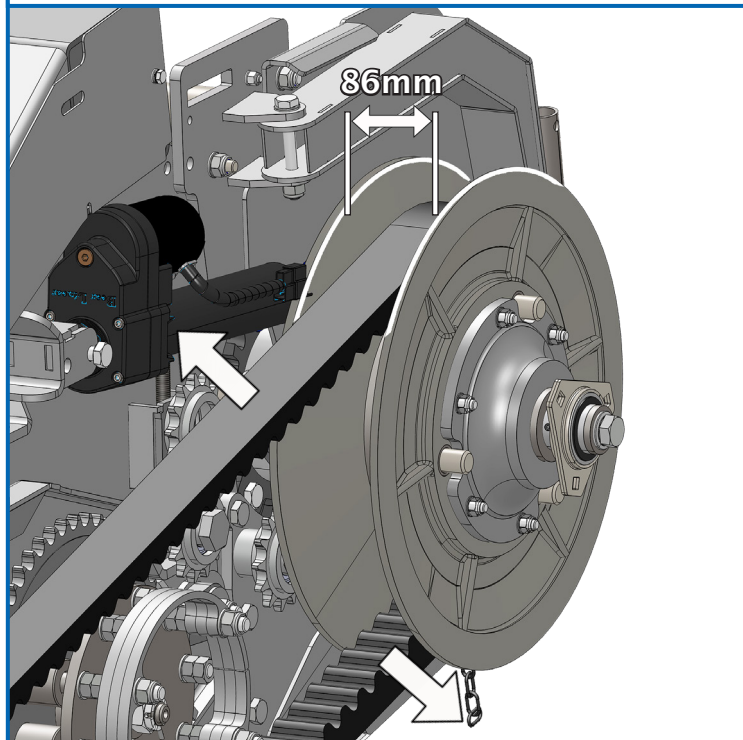

24. Refit the washer and tie rod. If your gearbox shaft has a groove (older models), align it with the tie rod bearing grubscrew.

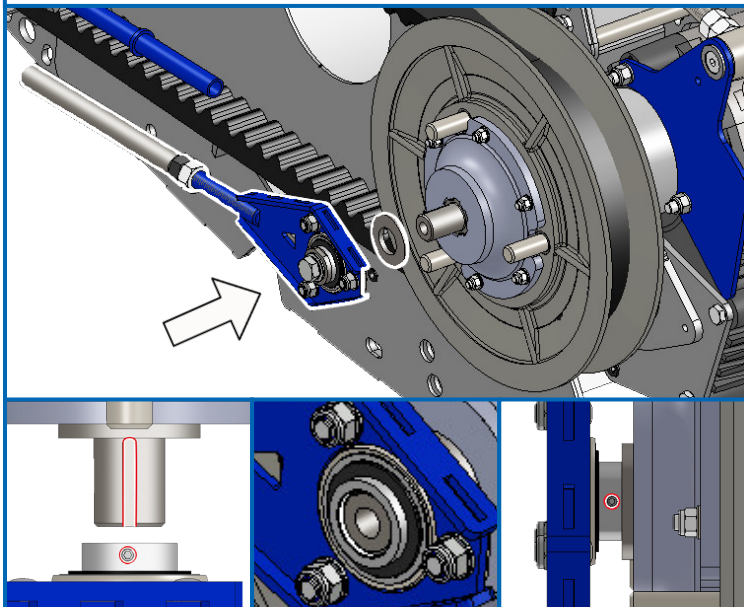

The bearing overhangs the shaft by 6mm. On earlier models turn the bearing insert around so the grubscrews are inside.

25. Tighten the bearing fasteners on both the front and rear pulleys.

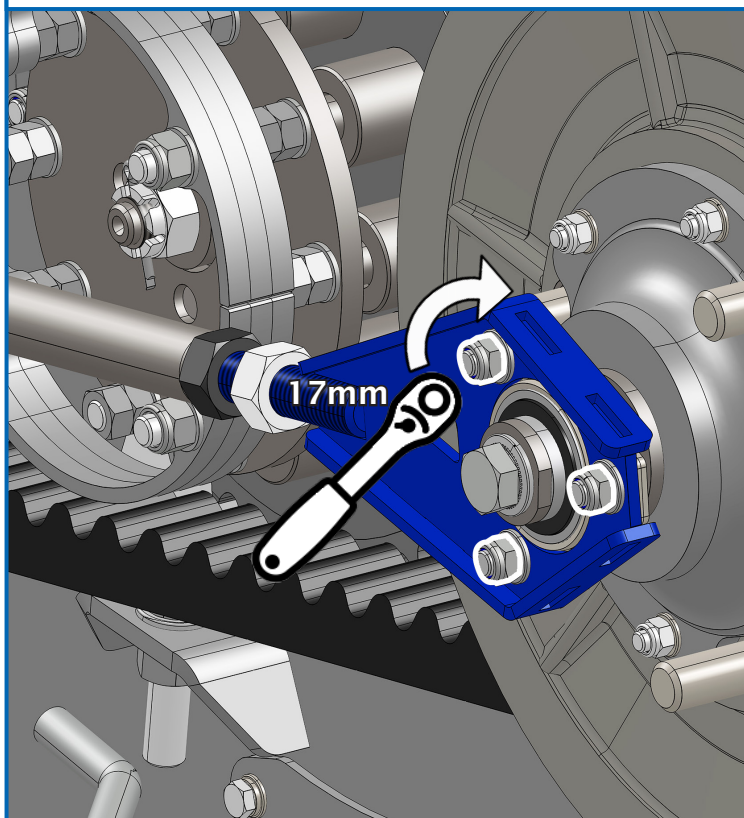

26. Apply threadlocker and tighten the fastener. Ensure the pulleys are fully open and the belt is still able to move freely.

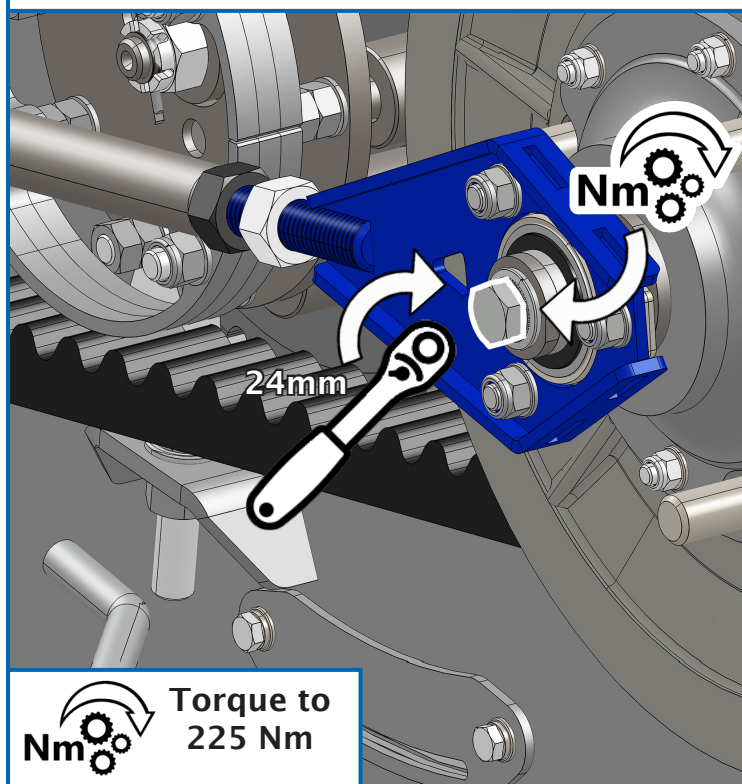

27. Apply threadlocker and tighten both grub screws.

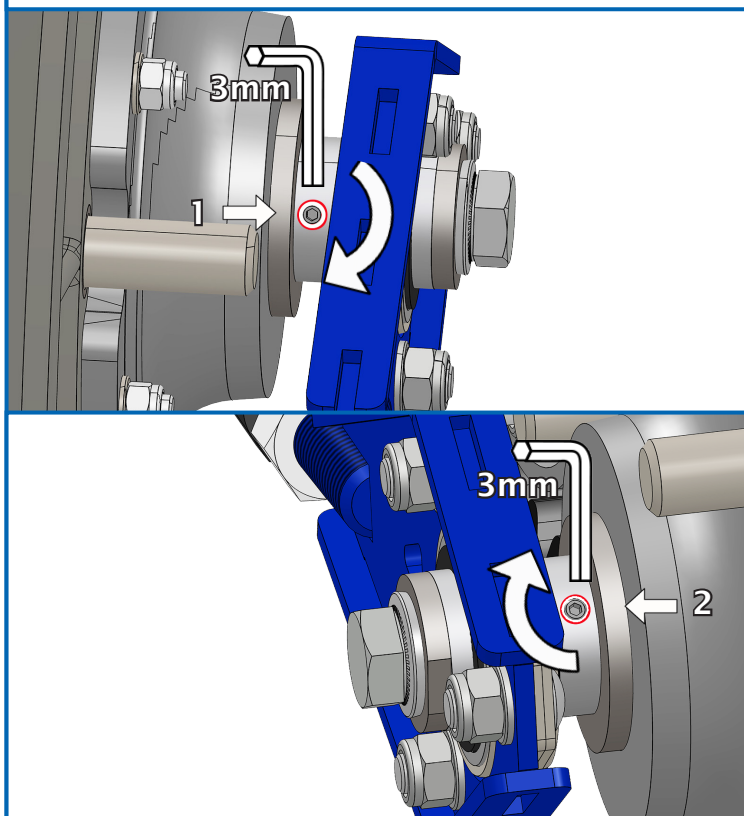

28. Refit the tie rod support bracket.

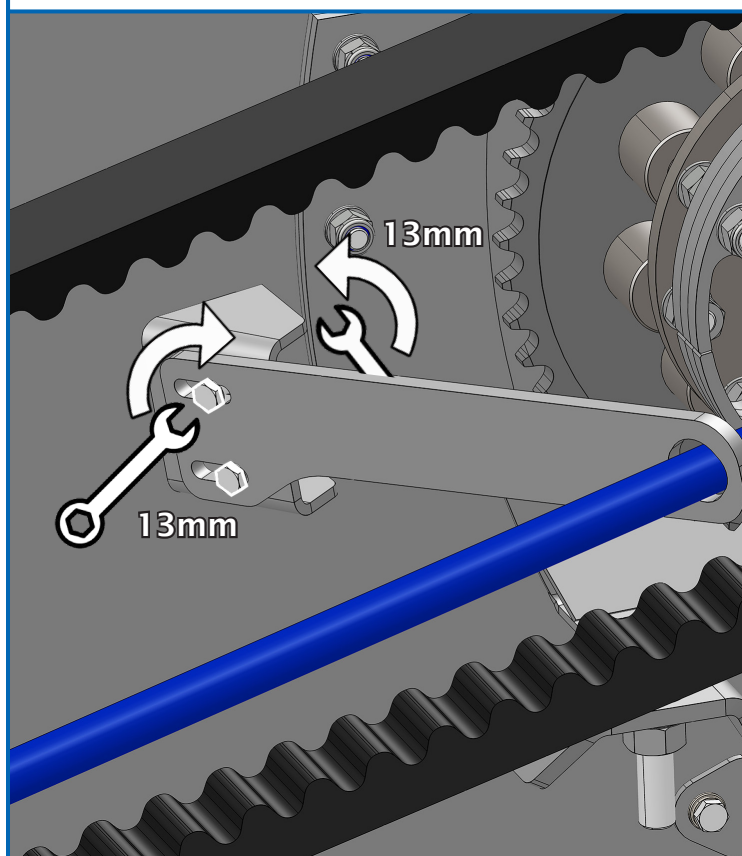

29. Reset the tie rod and tighten the lock. Tighten until taught, then turn 1/6 of a turn and tighten the lock nut.

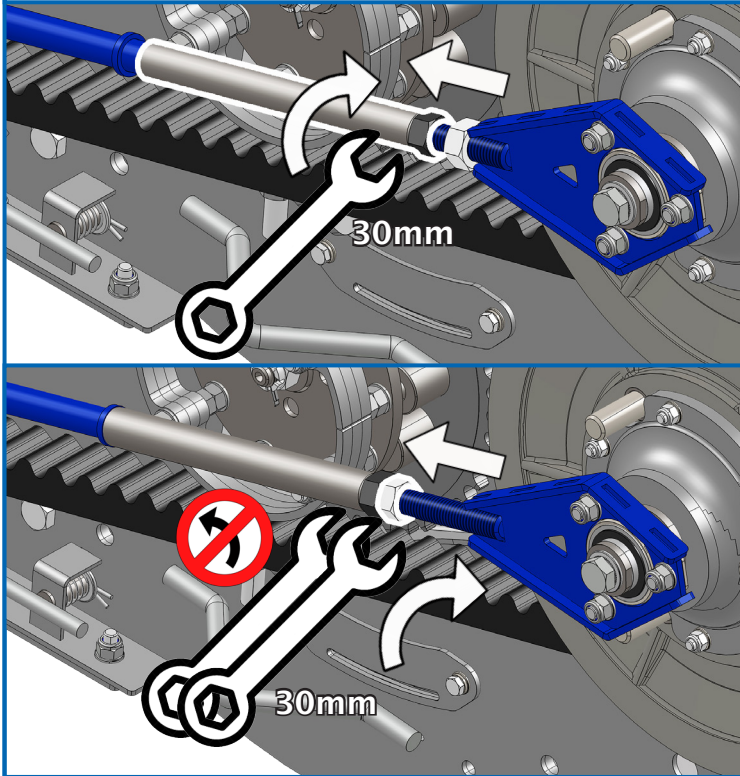

30. Remove the wedge from the front pulley.

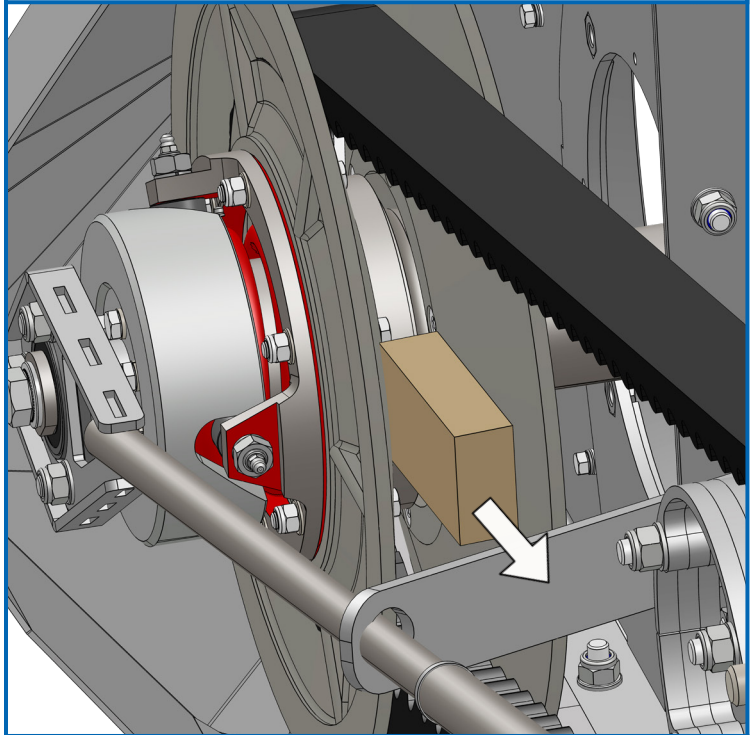

DO NOT put hands between pulley sheaves.

31. Turn over the drive manually. Rotate the drive system to ensure no components are catching. Listen for the front pulley spring re-tensioning.

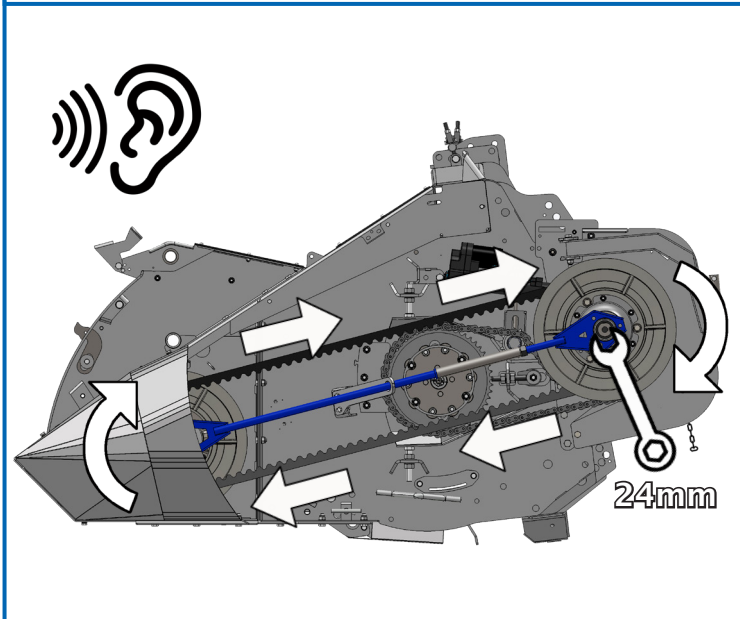

DO NOT touch belt or pulleys, use a wrench.

32. Check the front pulley gap is 61 mm. The rear pulley gap should be fully open and measure 86 mm.

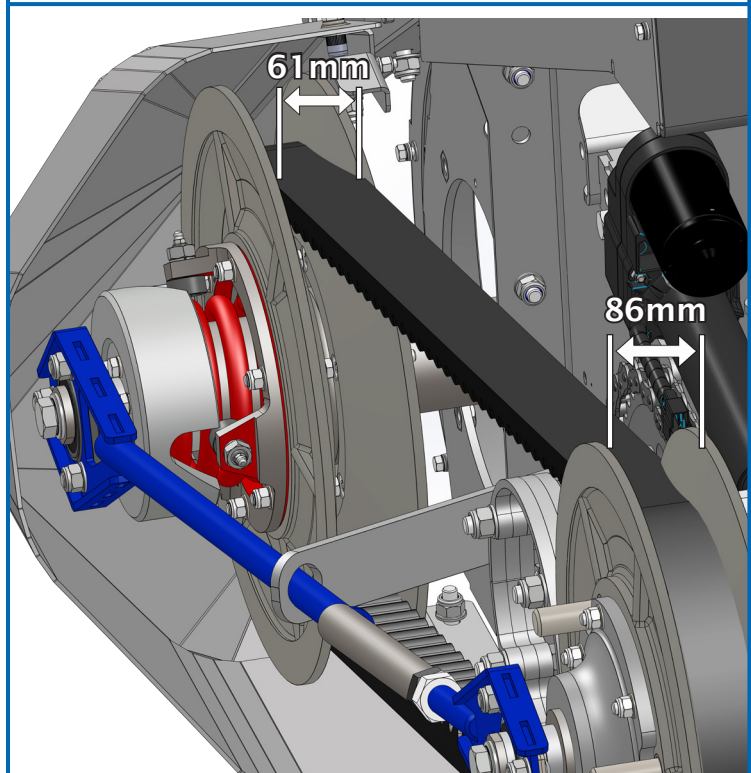

33. Pivot the gearbox if necessary.

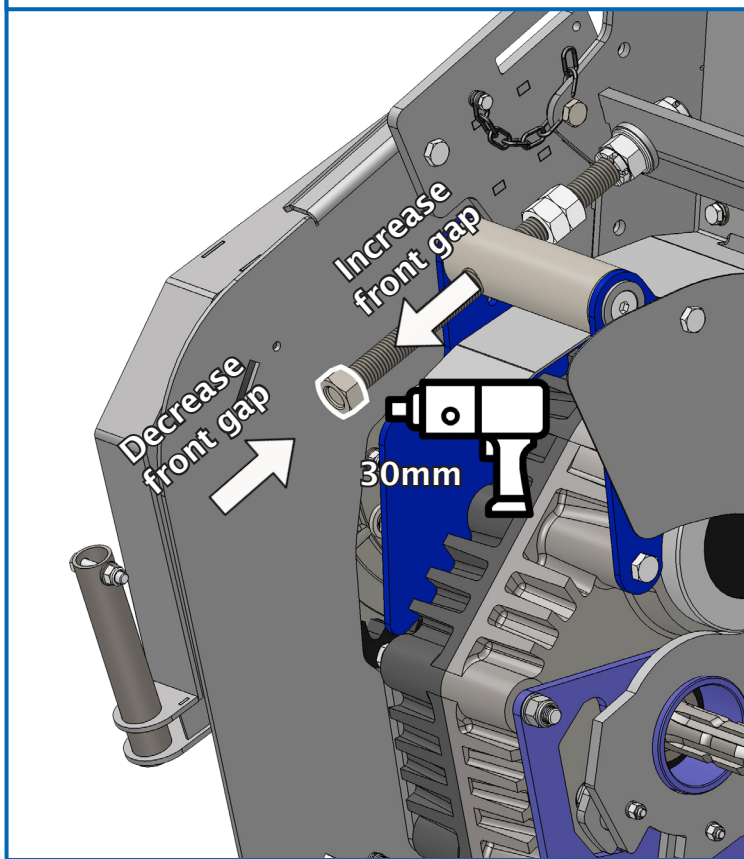

34. Turn over the drive manually after adjusting the gearbox position. Rotate the drive system to allow the belt to re-settle in the pulleys.

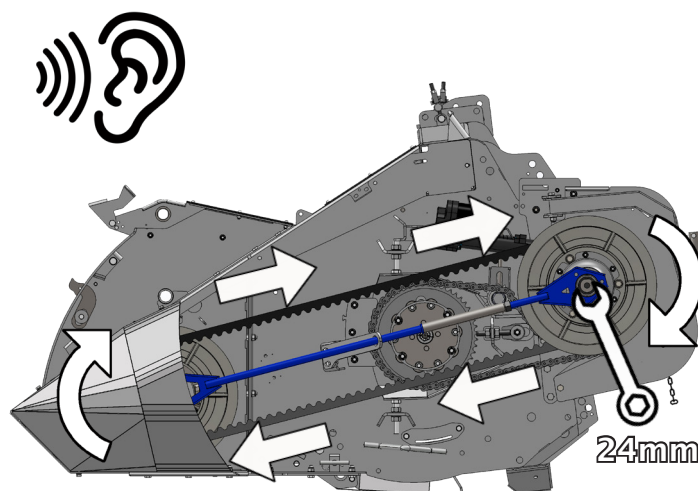

DO NOT touch belt or pulleys, use a wrench.

35. Refit the drive guard.

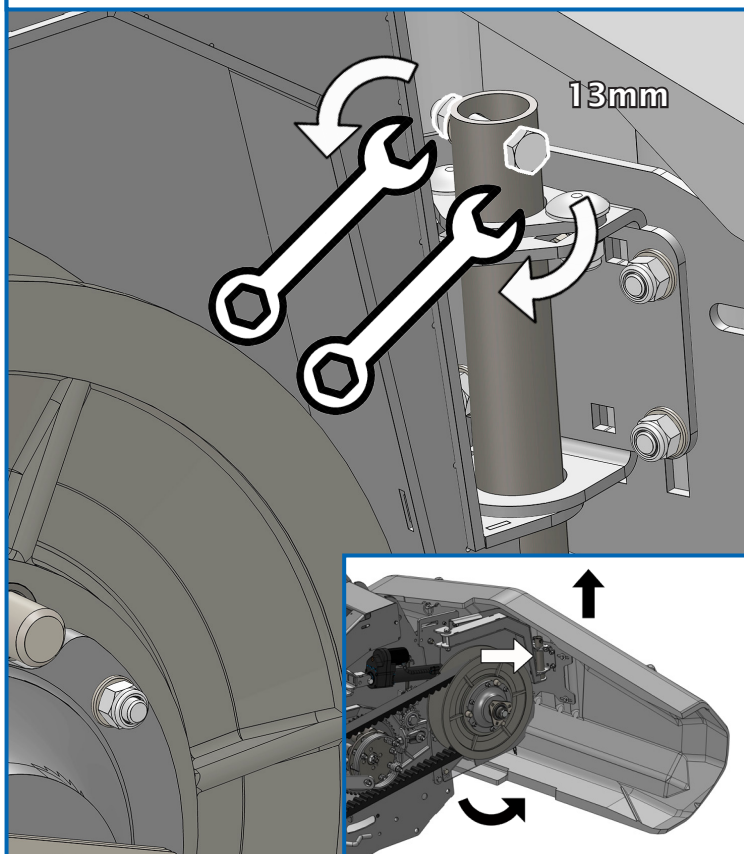

36. Run up the machine.

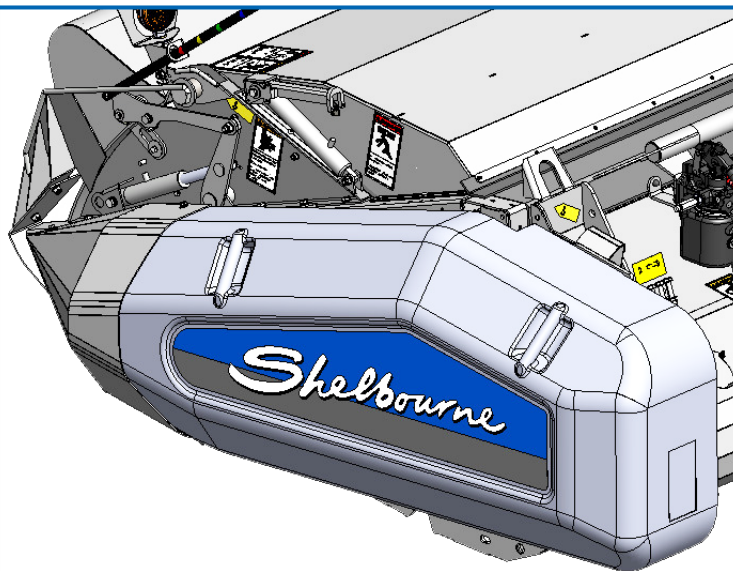

Make sure the guard is closed before running up.

Shelbourne Reynolds Engineering Limited

| ASSY NUMBER: KIT-01463 | | | | ASSY DESCRIPTION: REAR PULLEY ASSY & ACTUATOR CAM KIT | | | |
|------------------------|--------------|--|-----|---|-----------|--|-----|
| ITEM | PART NO | DESCRIPTION | QTY | ITEM | PART NO | DESCRIPTION | QTY |
| 1 | 199350 01 | OUTER PULLEY HUB | 1 | 25a | 292710 01 | FOLDED ACTUATOR BRKT | 1 |
| 2 | 198270 01 | OUTER REAR PULLEY | 1 | or | 292740 01 | XCV 2012 AND ON (ALL YEARS) & CVS 2018 & ON (PRE-ASSEMBLED) | 1 |
| 3 | SCEA08353 | CSK SCREW | 12 | | | | |
| 4 | WSH-0012 | PLAIN WASHER | 17 | 25b | | RH ACTUATOR BRKT (1 NOTCH) | |
| 5 | NUT-0263 | NYLOC NUT | 17 | | | CVS & RVS 2001-2017 | |
| 6 | ORA300750 | O RING | 1 | 26 | WSH-0019 | PLAIN WASHER | 1 |
| 7 | 198274 01 | SPIGOT | 3 | 27 | WSH-0018 | PLAIN WASHER | 1 |
| 8 | SCW-4528 | GRUB SCREW | 1 | 28 | BLTA12350 | HEX HD BOLT | 1 |
| 9 | 199410 01 | INNER PULLEY HUB | 1 | 29 | NUT-0270 | NYLOC NUT | 1 |
| 10 | 198271 01 | INNER PULLEY | 1 | 30 | HSS-0150 | SETSCREW | 2 |
| 11 | 190119 11 | WASHER | 3 | 31 | WSHA30161 | LOCKWASHER | 1 |
| 12 | WSH-0061 | SPRING WASHER | 3 | 32 | HSS-0316 | SETSCREW | 1 |
| 13 | HSS-0191 | SETSCREW | 3 | | | | |
| 14 | NIP-00620 | GREASE NIPPLE | 1 | | | | |
| 15 | BRG-19500NC3 | BEARING | 2 | | | | |
| 16 | 292733 01 | STATIC CAM | 1 | | | | |
| 17 | 291809 01 | BUSH | 3 | | | | |
| 18 | ORA120080 | O RING | 1 | | | | |
| 19 | HSS-0153 | SETSCREW | 3 | | | | |
| 20 | 292736 01 | CAM ARM SPACER | 1 | | | | |
| 21a | 292737 01 | BOLT ON STATIC CAM PLATE | 1 | | | | |
| or | | XCV 2012 AND ON (ALL YEARS) & CVS 2018 & ON (PRE-ASSEMBLED) | | | | | |
| 21b | 292739 01 | BOLT ON STATIC CAM (1 NOTCH) | 1 | | | | |
| or | | CVS & RVS 2007-2017 | | | | | |
| 21c | 292741 01 | CVS & RVS 2001-2006, WITHOUT ROTOR GEARBOX | 1 | | | | |
| | | STATIC CAM PLATE (2 NOTCHES) | | | | | |
| | | CVS & RVS 2001-2006, WITH ROTOR GEARBOX | | | | | |
| 22 | 292704 01 | ACTUATOR CAM W/A | 1 | | | | |
| 23 | 292695 01 | BEARING BOSS | 1 | | | | |
| 24a | 292709 01 | ACTUATOR BRKT | 1 | | | | |
| or | | XCV 2012 AND ON (ALL YEARS) & CVS 2018 & ON (PRE-ASSEMBLED) | | | | | |
| 24b | 292740 02 | RH ACTUATOR BRKT (1 NOTCH) | 1 | | | | |
| | | CVS & RVS 2001-2017 | | | | | |

TIPS TO ASSIST IDENTIFYING YOUR MACHINE MODEL AND YEAR:

XCV- SPRUNG, PIVOTING ADAPTOR PLATE WITH GAUGE WHEELS AT REAR OF HEADER.

CVS & RVS - BOLTED ADAPTOR PLATE, BRACING TUBE ACROSS TOP OF MACHINE.

LOCATE SERIAL NUMBER ON THE REAR LH OR RH END OF THE MACHINE.

7 DIGIT SERIAL NUMBERS 2000-2009
EXAMPLE '2122843'
1ST 2ND & 3RD DIGITS ARE FACOTRY BUILD NUMBERS, 4TH & 5TH IS THE SIZE OF MACHINE IN FEET (28'), 6TH DIGIT IS A FACTORY MACHINE TYPE NUMBER & 7TH DIGIT IS YEAR OF MANUFACTURE (2003).

11 DIGIT SERIAL NUMBERS 2010 AND ON
EXAMPLE 'XCV42198964',
1ST, 2ND & 3RD LETTERS SHOW THE TYPE OF MACHINE (XCV), 4TH & 5TH DIGITS SHOW THE MACHINE SIZE (42'), 6TH & 7TH DIGIT SHOW THE MODEL YEAR (2019), REMAINING DIGITS ARE FACTORY BUILD NUMBERS.

TIPS TO ASSIST IDENTIFYING YOUR MACHINE MODEL AND YEAR:

XCV- SPRUNG, PIVOTING ADAPTOR PLATE WITH GAUGE WHEELS AT REAR OF HEADER.

CVS & RVS - BOLTED ADAPTOR PLATE, BRACING TUBE ACROSS TOP OF MACHINE.

LOCATE SERIAL NUMBER ON THE REAR LH OR RH END OF THE MACHINE.

7 DIGIT SERIAL NUMBERS 2000-2009

EXAMPLE '2122843'

1ST 2ND & 3RD DIGITS ARE FACTORY BUILD NUMBERS, 4TH & 5TH IS THE SIZE OF MACHINE IN FEET (28'), 6TH DIGIT IS A FACTORY MACHINE TYPE NUMBER & 7TH DIGIT IS YEAR OF MANUFACTURE (2003).

11 DIGIT SERIAL NUMBERS 2010 AND ON

EXAMPLE 'XCV42198964'

1ST, 2ND & 3RD LETTERS SHOW THE TYPE OF MACHINE (XCV), 4TH & 5TH DIGITS SHOW THE MACHINE SIZE (42'), 6TH & 7TH DIGIT SHOW THE MODEL YEAR (2019), REMAINING DIGITS ARE FACTORY BUILD NUMBERS.

Shelbourne Reynolds Engineering Limited

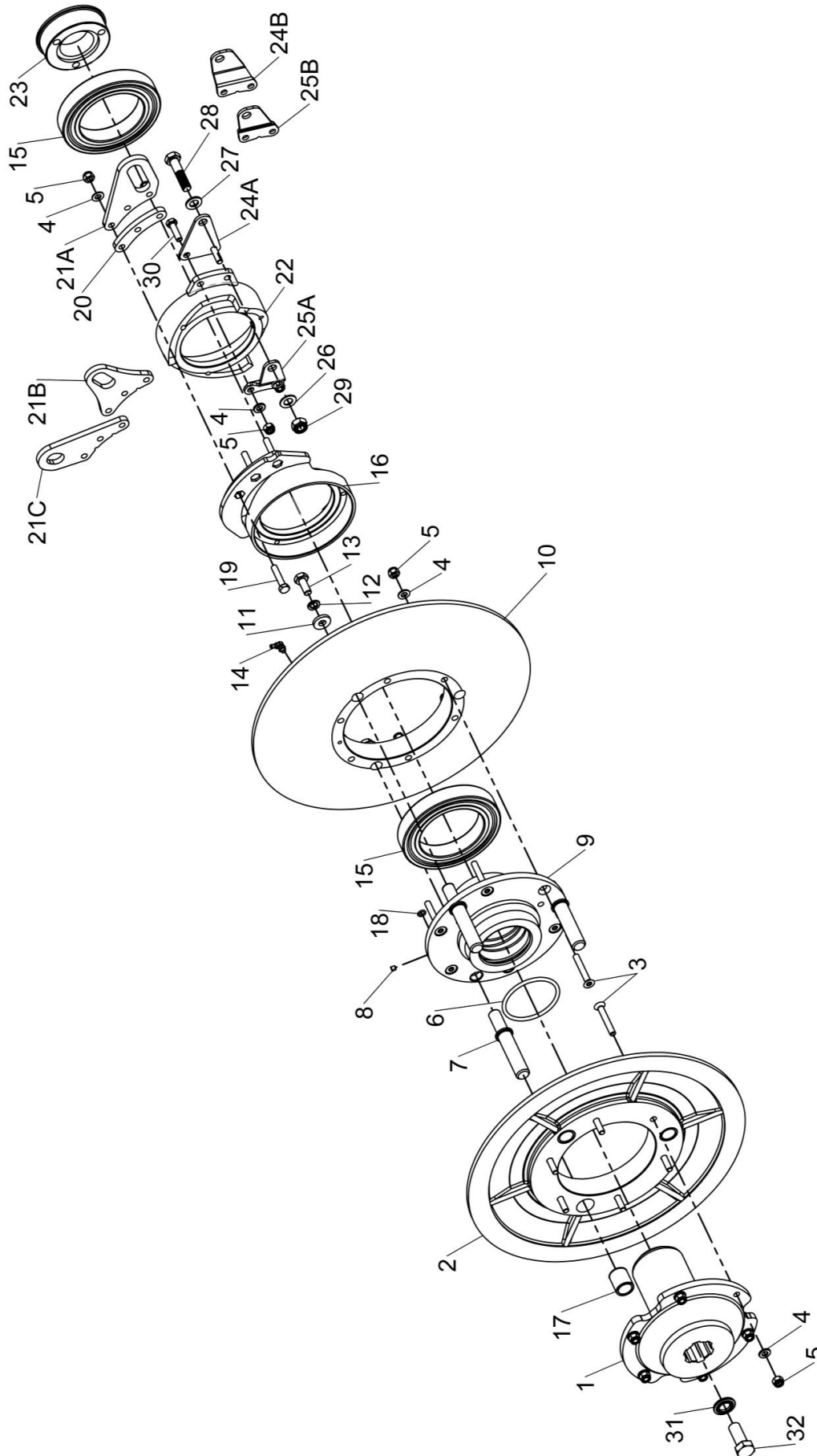

KIT-01463
KIT-01463A

