

Fitting Instructions

Issue	Date	Changes
1	16/01/2024	Fitting Instructions Created



Safety Warning

These Fitting Instructions are for informational purposes only. Shelbourne Reynolds makes no representation or warranty, express or implied, regarding the information provided herein. Under no circumstances will Shelbourne Reynolds have any liability to you for any loss or damage resulting from the use of these instructions or reliance on any information provided. It is extremely dangerous to carry out any work on a machine while it is under power. Never remove or reattach any parts unless the machine is fully turned off and disengaged.

Please read all safety instructions contained in your operators manual and observe all safety signs attached to the Stripper header. Your use of these instructions is solely at your own risk.

Please use proper safety equipment at all times.



Refer to the Operators Manual for additional information and Safety procedures.

These instructions are worded if the kit was being installed while the header is mounted on a combine, to have the stripping rotor set in the fastest position and implement the safe stop procedure.

If not the pulley drive and actuator may need rotating and cycling to assist.

Recommended Tools List

13mm Socket + Extension
17mm Socket
19mm Socket
24mm Socket (for ½" Impact)
30mm socket (for ½" Impact)
3mm Allen Key

13mm Wrench
19mm Wrench
2 x 30mm Wrenches
M10 x 1.5 Tap
Hydraulic Press (Optional)
Anti-Seize / Copper slip

Block Of Wood
Large Mallet
Tie Wraps
2 Medium Pry Bars
Large Pry Bar
Thread Lock (Loctite)

All the information in these Fitting Instructions is also contained in a video, scan the QR code to access.



1. Run the machine until rotor pulley is fully open, rotor speed at maximum.



Stop the machine and implement the safe stop.

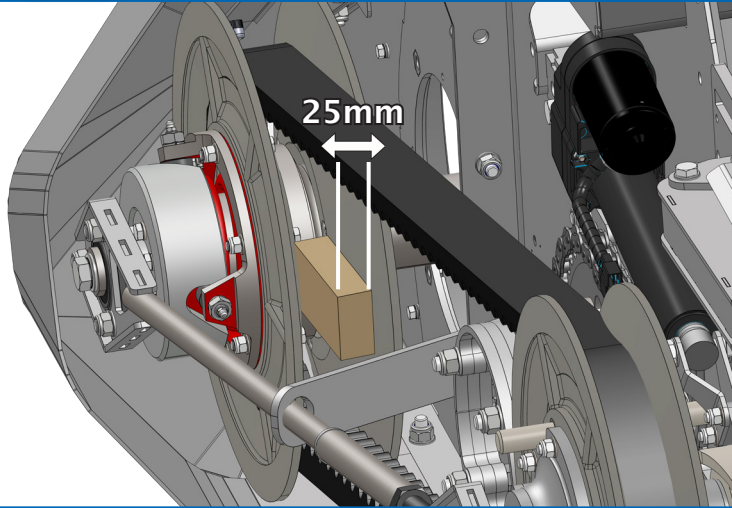

Open the drive guard and wedge pulley's open.



DO NOT put hands between pulley sheaves.

2. Remove the guard.

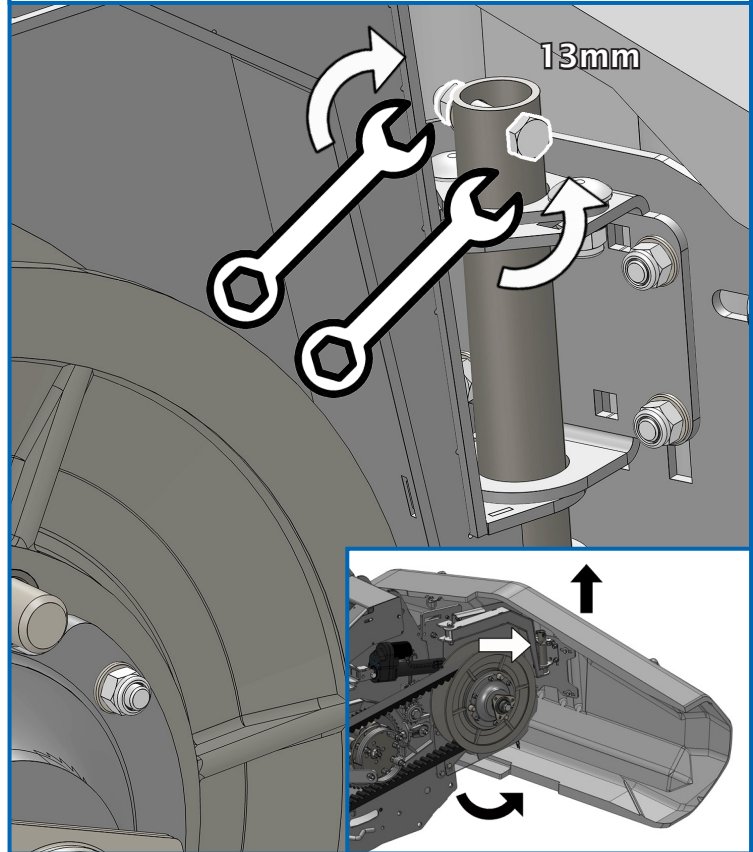

3. Loosen the tie rod.

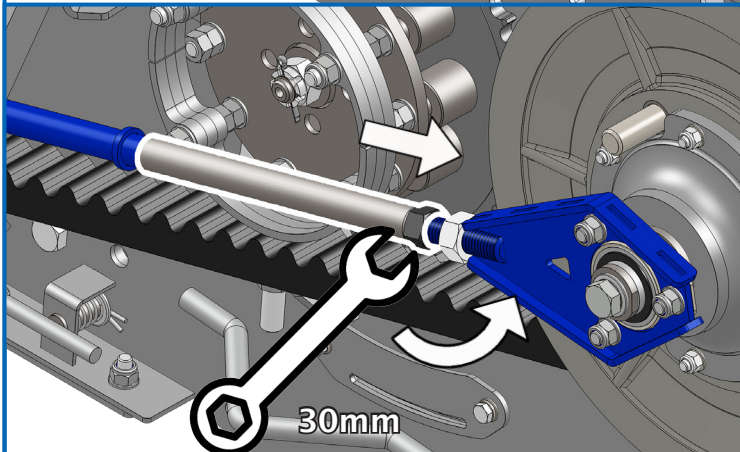
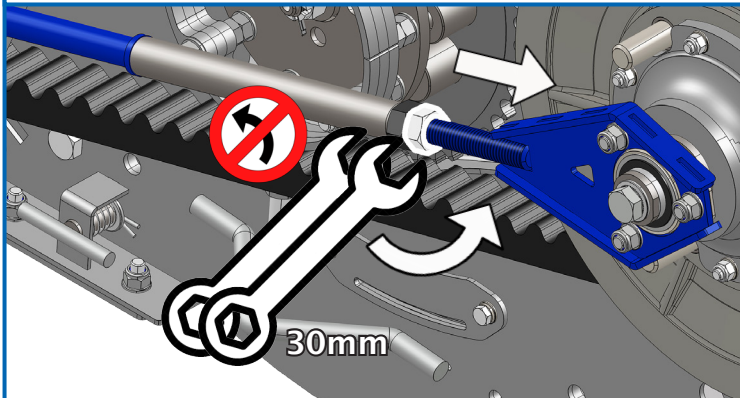

4. Loosen the tie rod support fasteners.

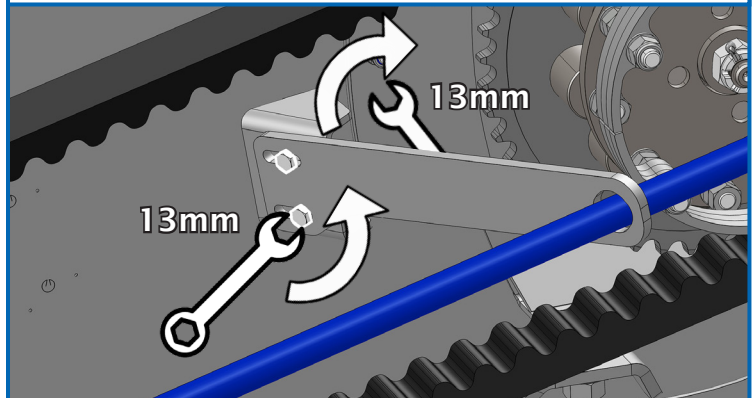

Move up and down to ensure no binding on the tie rod or remove completely.

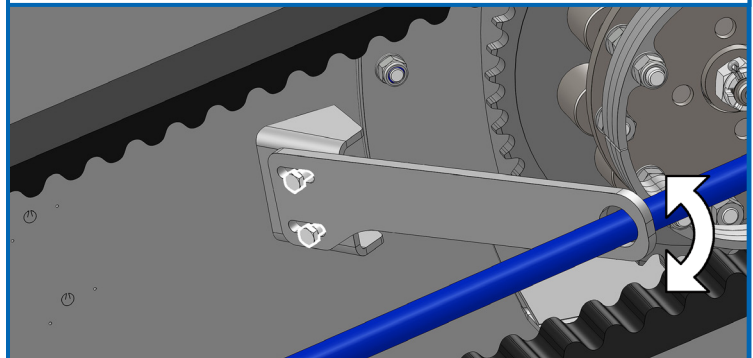

5. Loosen tie rod bearing grub screws (x2).

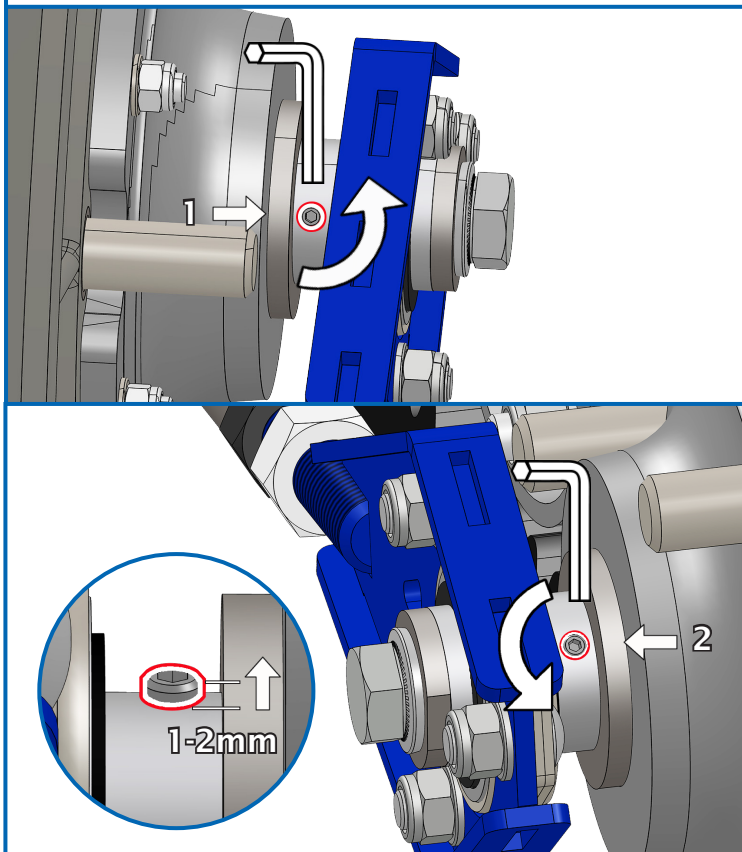

6. Loosen tie rod bearing fasteners on both front and rear pulleys.

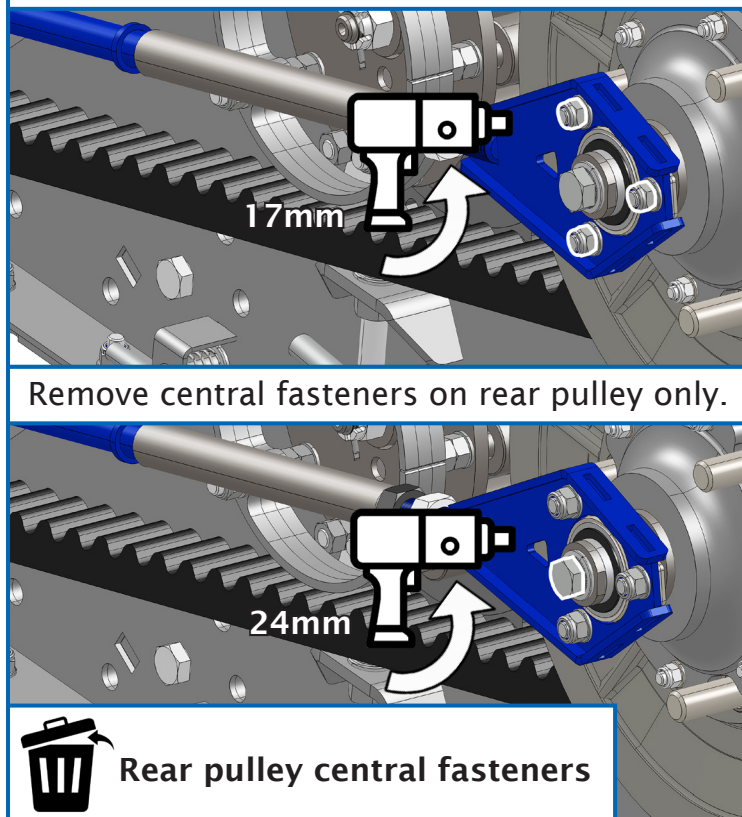

7. Remove the tie rod.

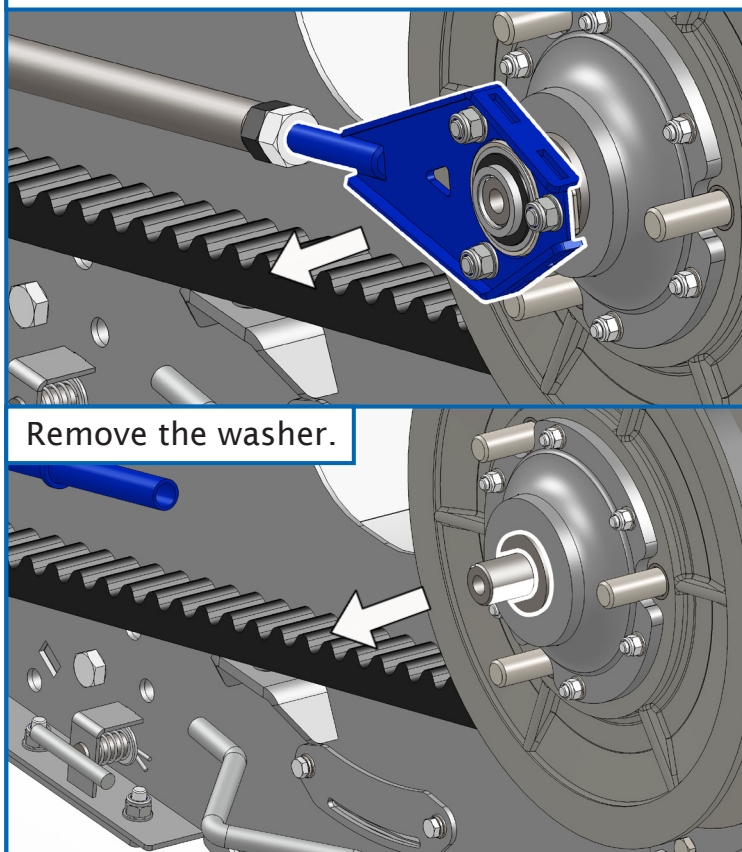

8. Electrically close the actuator fully.

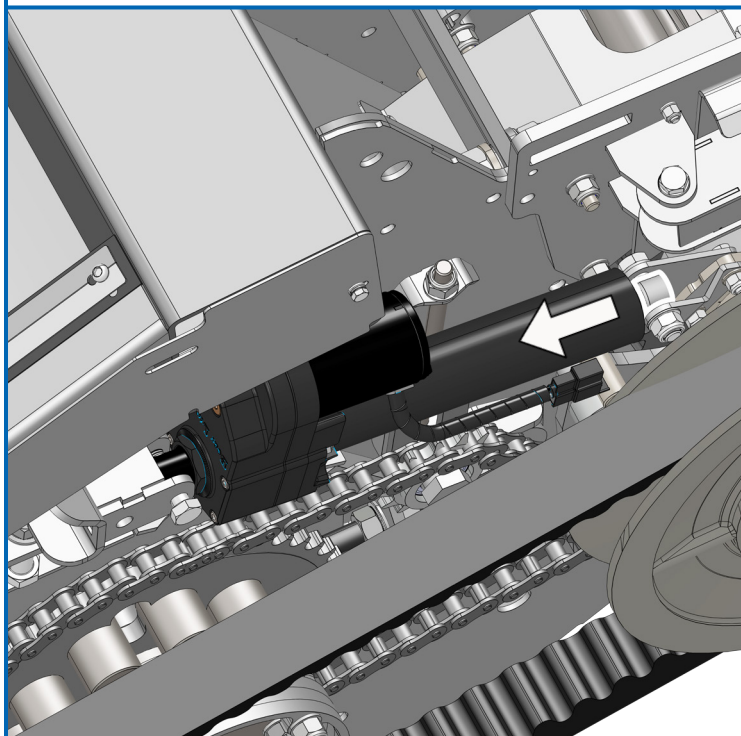

DO NOT run the header up.

9. Remove pulley assembly.

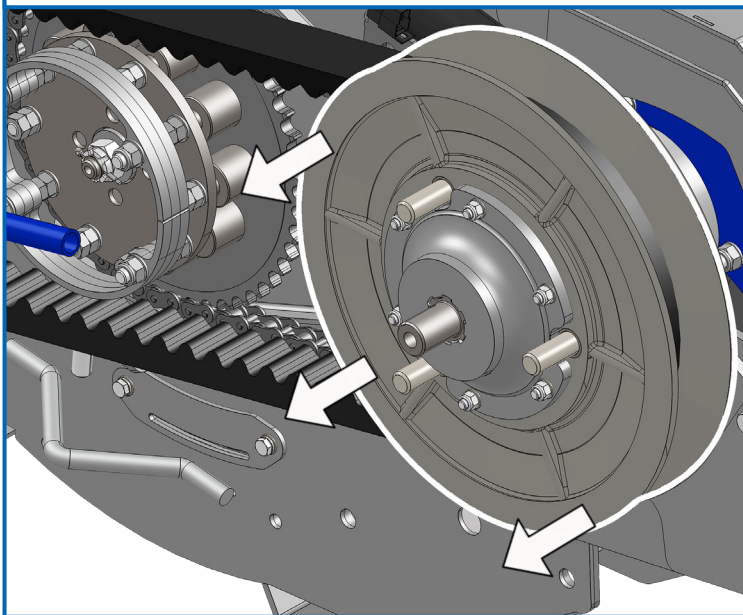

Old pulley assembly.



Take care when removing the pulleys from the shafts, as they weigh 40KG (88lbs).

10. Remove the cam brackets to cam fasteners.

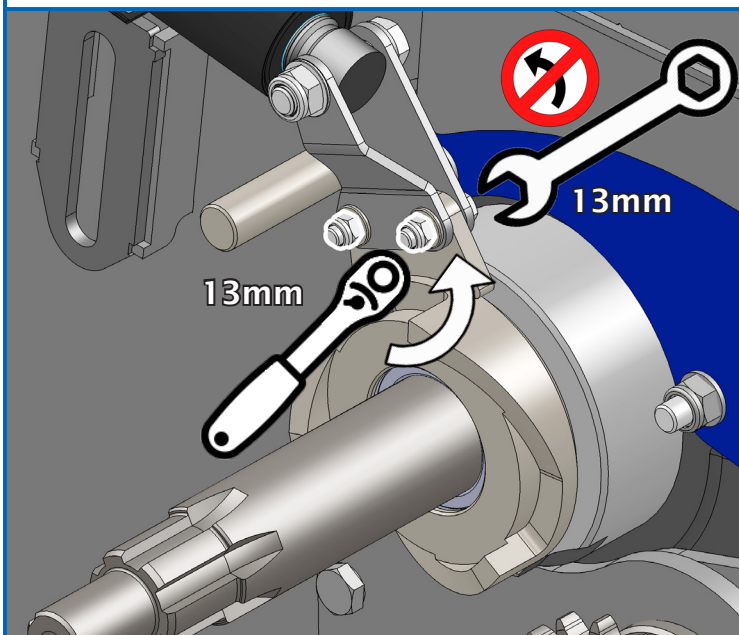

Pivot up the actuator and cable tie out of the way.



Cam fasteners.

11. Pry off the cam and bearing.

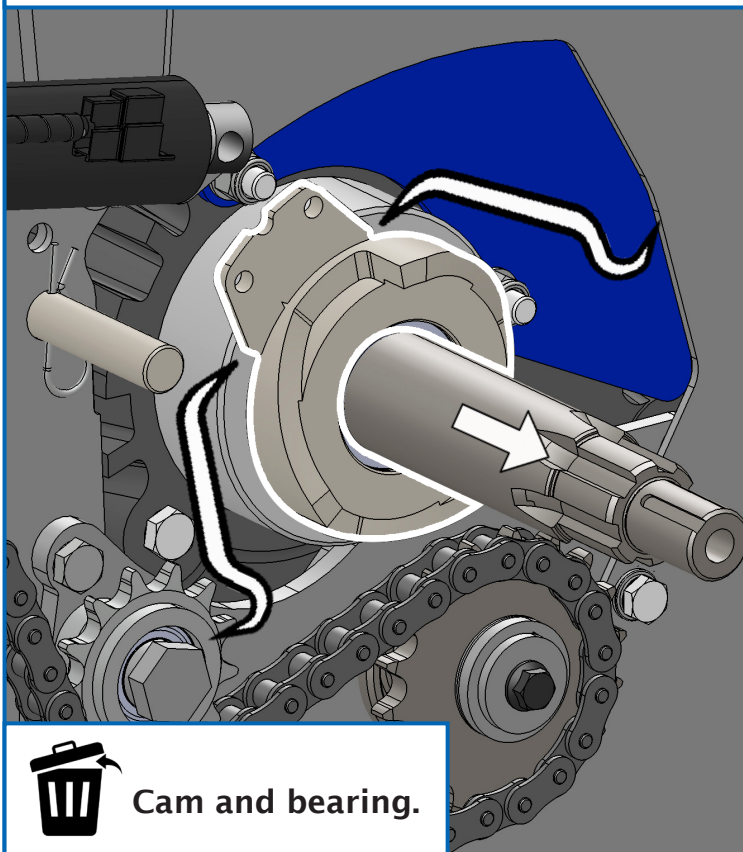

Cam and bearing.

12. Remove the actuator fastener holding on the old brackets and discard. Replace with new brackets.

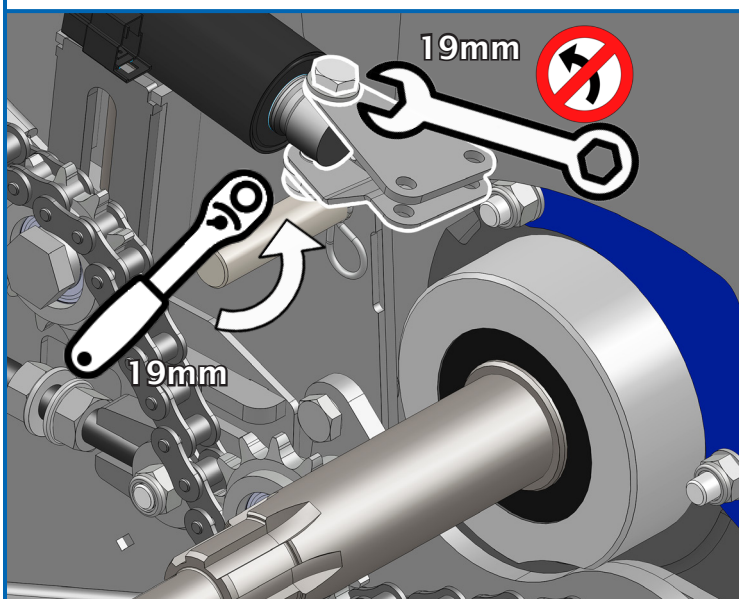

Twist the actuator rod to facilitate removing the bolt.



Actuator brackets and fastener.

13. Slide on the new cam assembly.

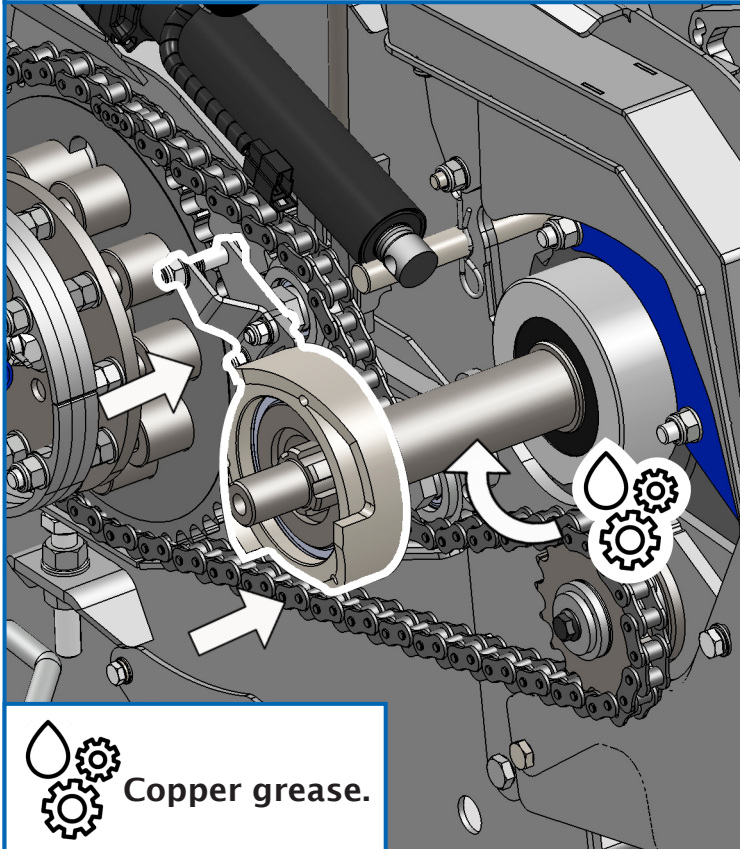

14. Separate the new pulley sheaves.

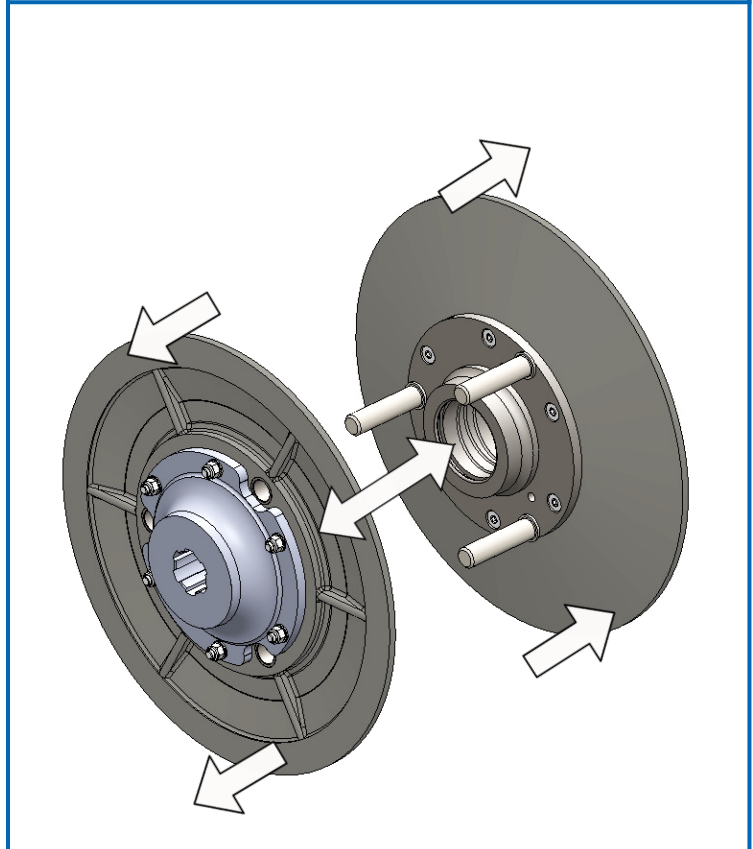

15. Temporarily fit the outer pulley half on the gearbox shaft.

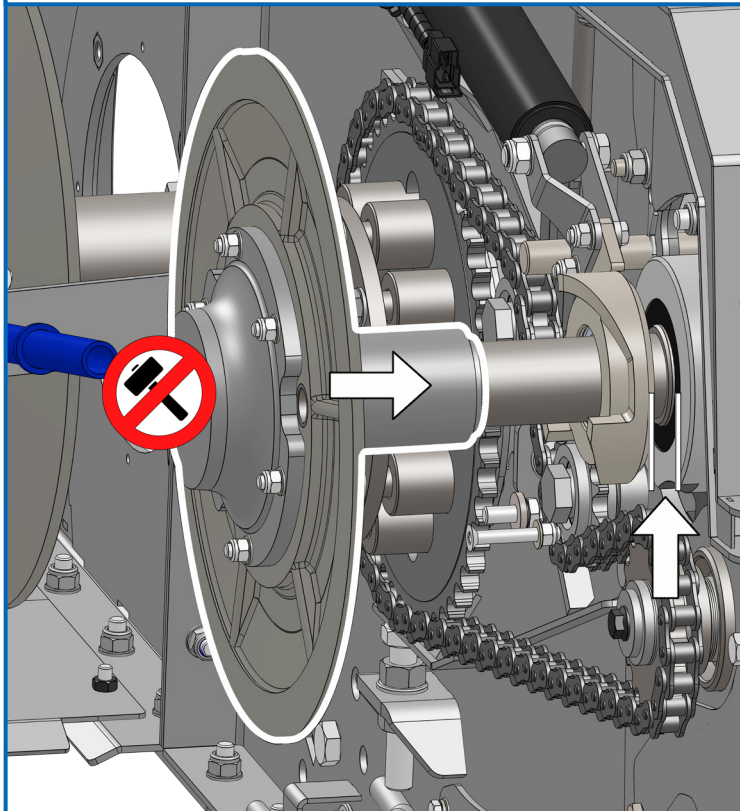

16. Use to push the cam fully home.

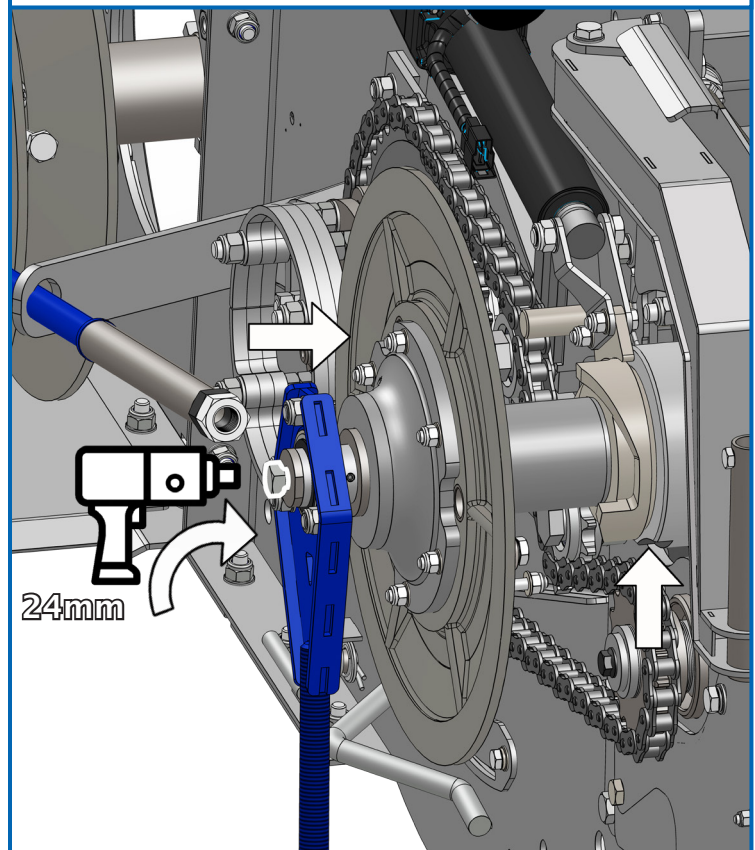

17. Remove the outer pulley half afterwards.

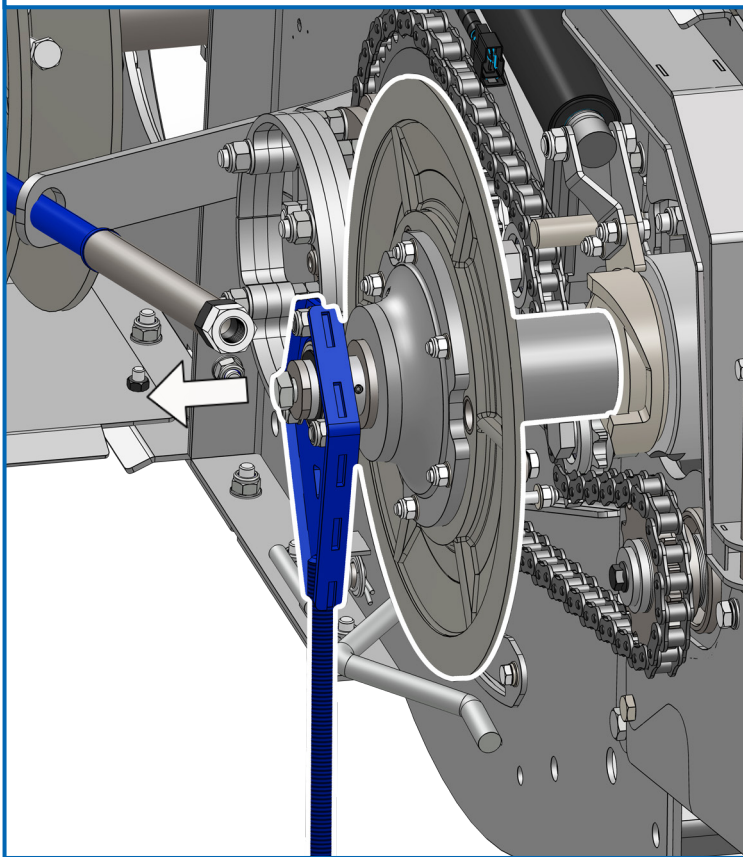

18. Remove the cable tie from the actuator and refit the cam bracket fasteners.

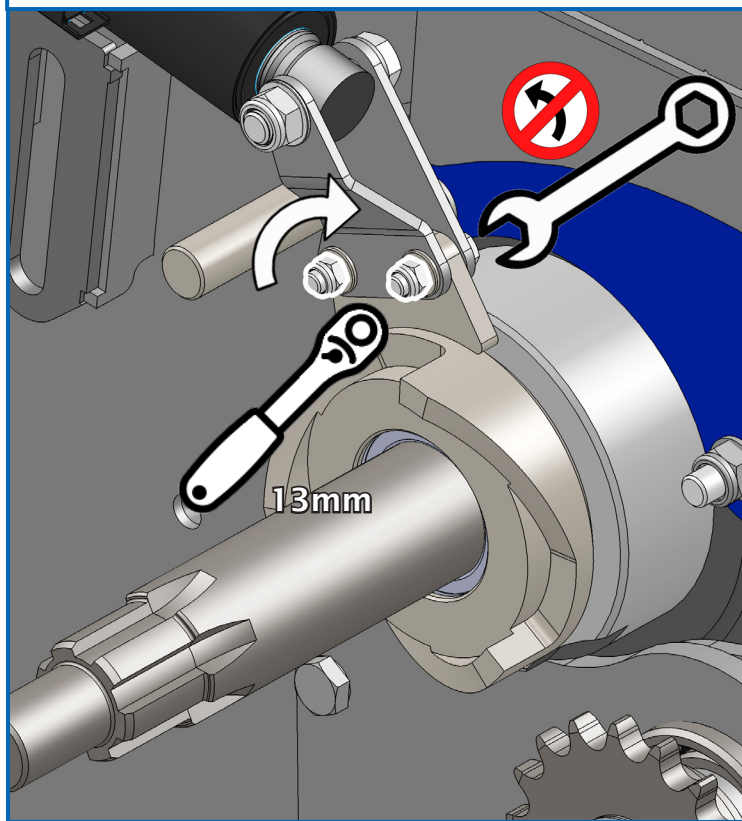

19. Reassemble the new pulley sheave, then grease the pulley assembly.

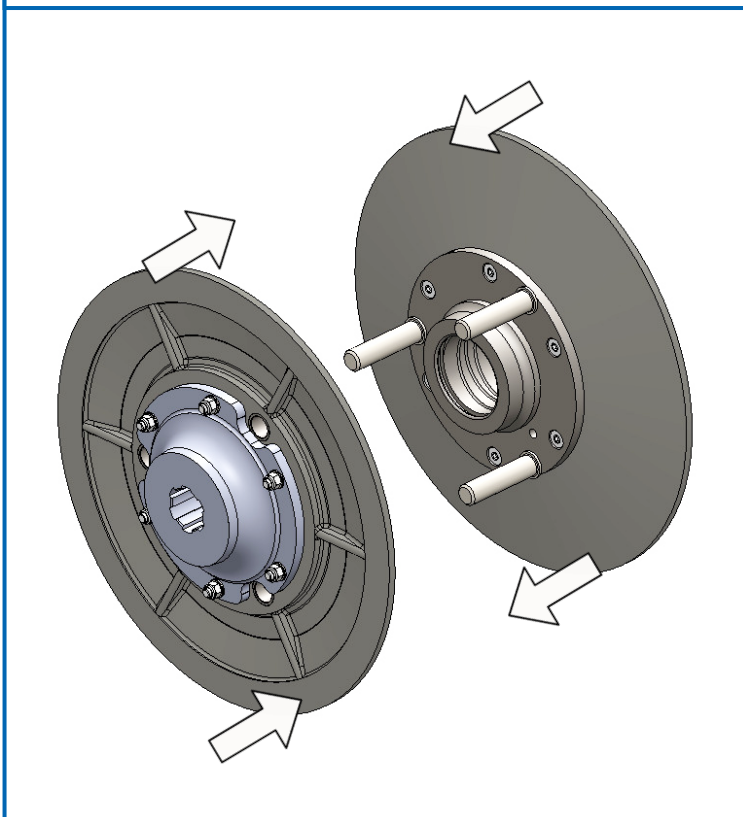

20. Slide the new pulley assembly with the belt inside on to the shaft.

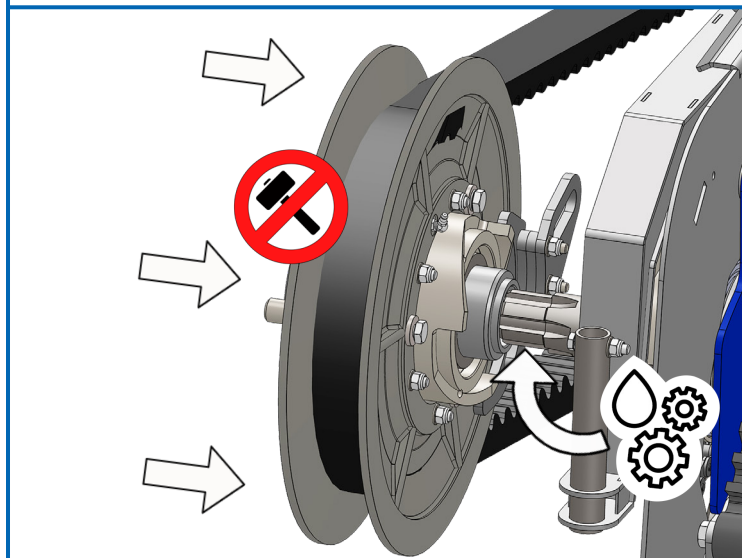

Molybdenum grease (black grease).



Take care when fitting the pulleys, as they weigh 40KG (88lbs).

21. Align the cam plate with the retaining bar.

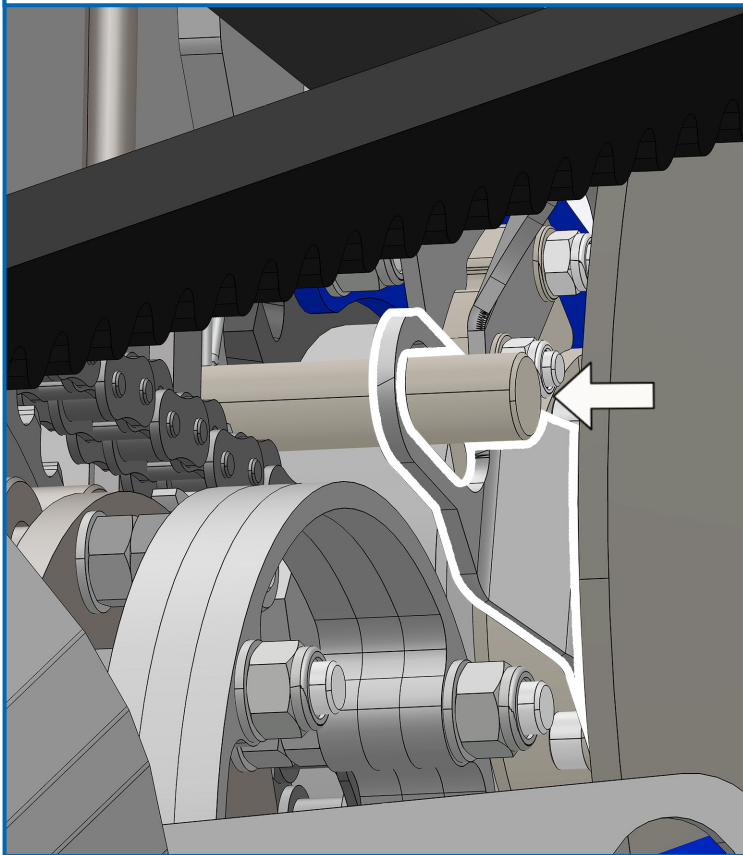

22. Push the new pulley assembly fully home.

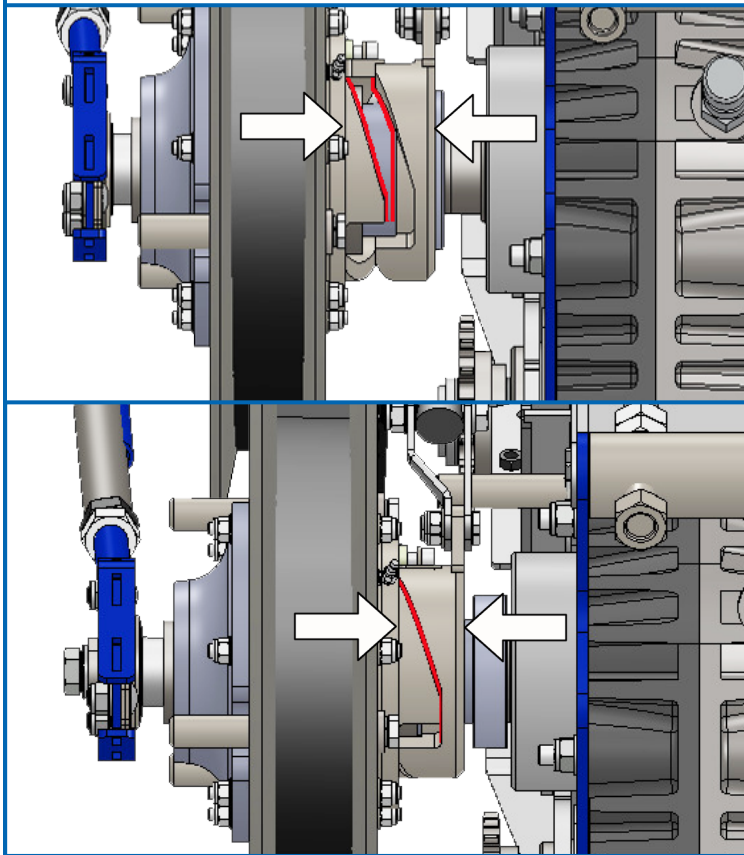

23. Check the belt moves freely between the fully open pulleys and isn't trapped or pinched. Check the dimension between the pulley sheaves is 86mm.

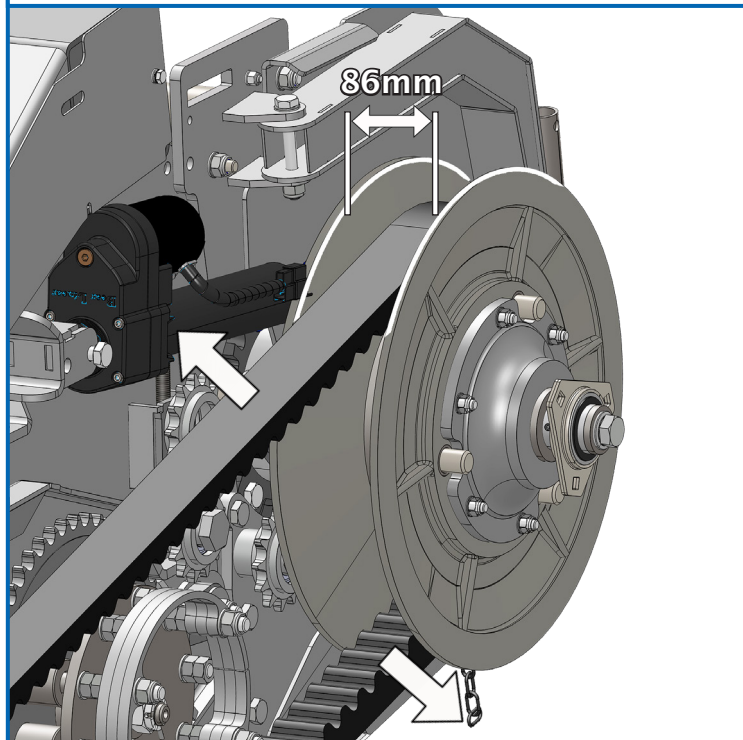

24. Refit the washer and tie rod. If your gearbox shaft has a groove (older models), align it with the tie rod bearing grubscrew.

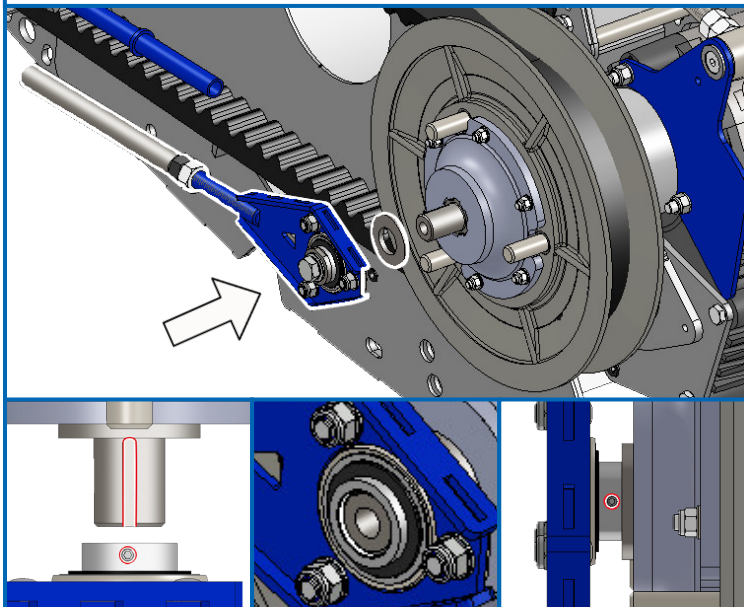

The bearing overhangs the shaft by 6mm. On earlier models turn the bearing insert around so the grubscrews are inside.

25. Tighten the bearing fasteners on both the front and rear pulleys.

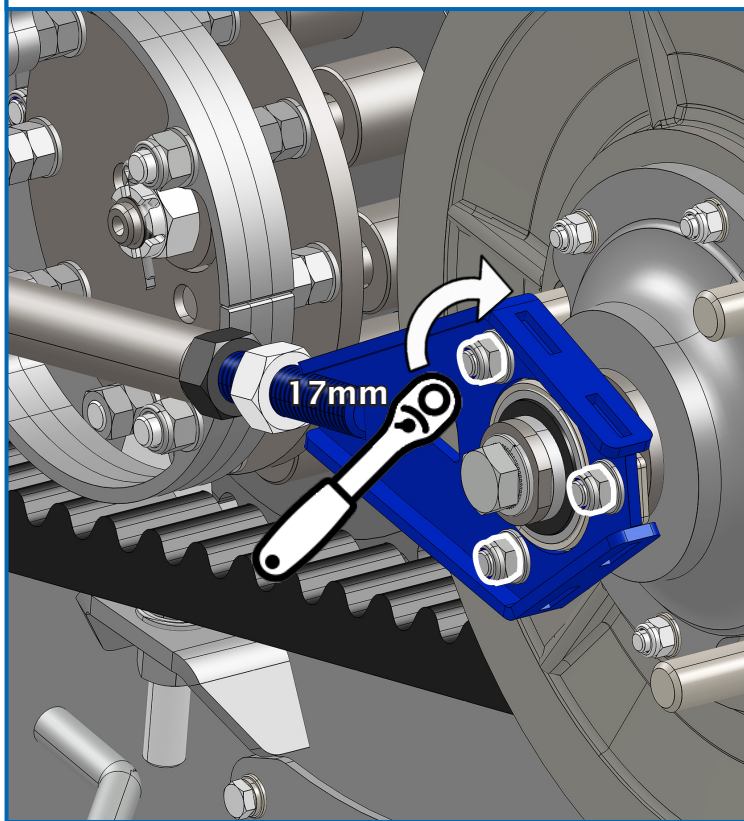

26. Apply threadlock and tighten the fastener. Ensure the pulleys are fully open and the belt is still able to move freely.

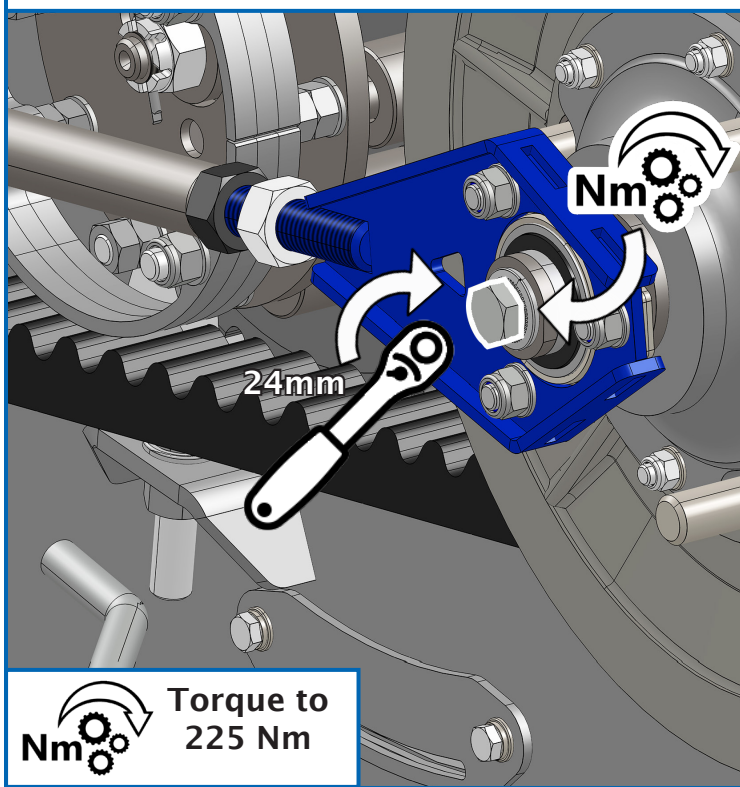

27. Apply threadlock and tighten both grub screws.

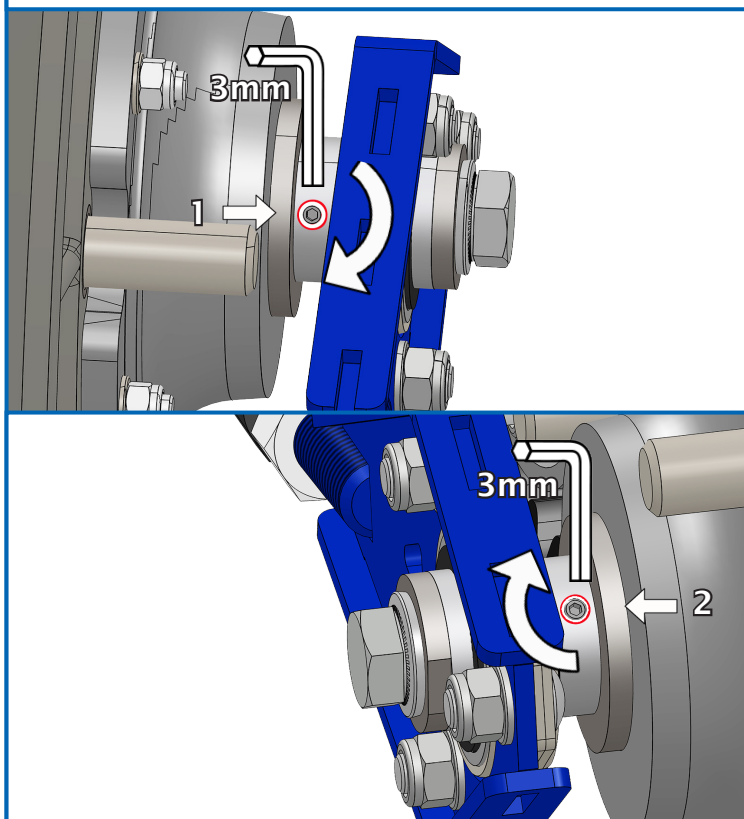

28. Refit the tie rod support bracket.

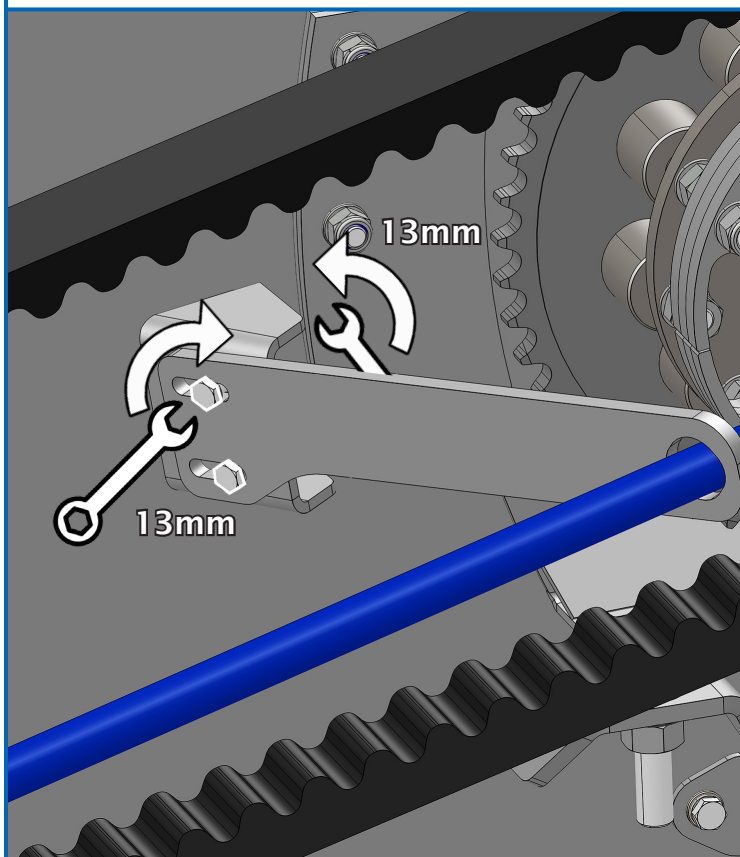

29. Reset the tie rod and tighten the lock. Tighten until taught, then turn 1/6 of a turn and tighten the lock nut.

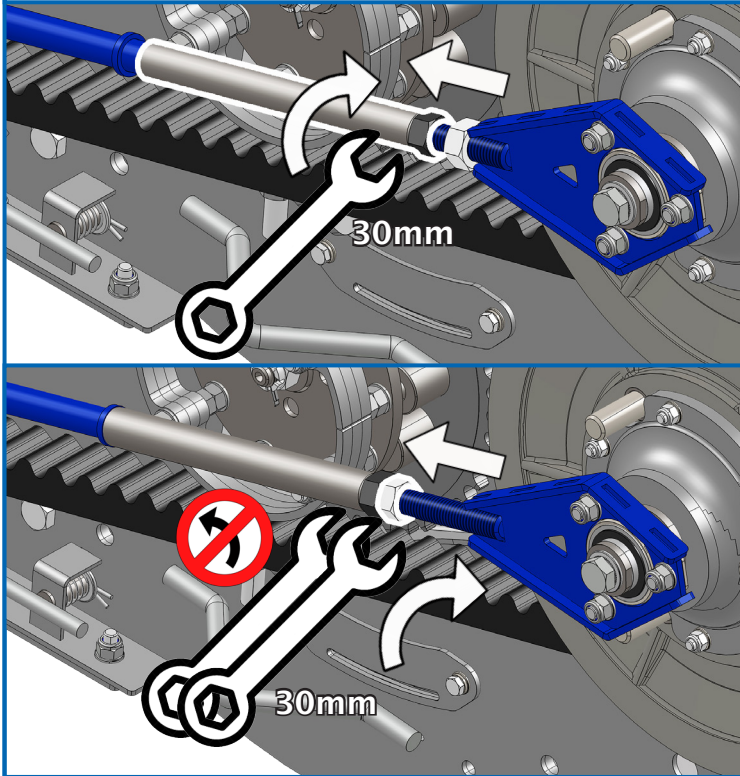

30. Remove the wedge from the front pulley.

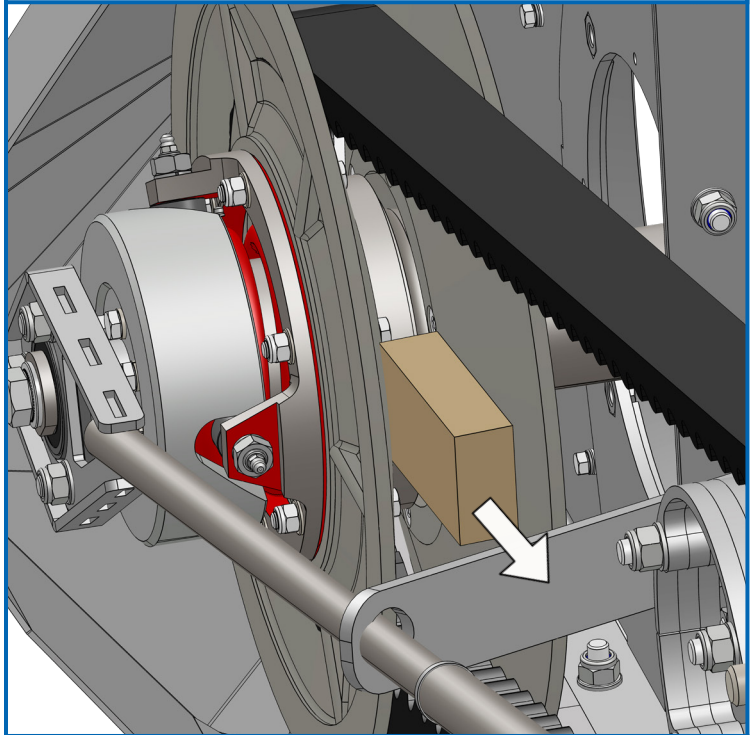

DO NOT put hands between pulley sheaves.

31. Turn over the drive by hand, Rotate the drive system to ensure no components are catching. Listen for the front pulley spring re-tensioning.

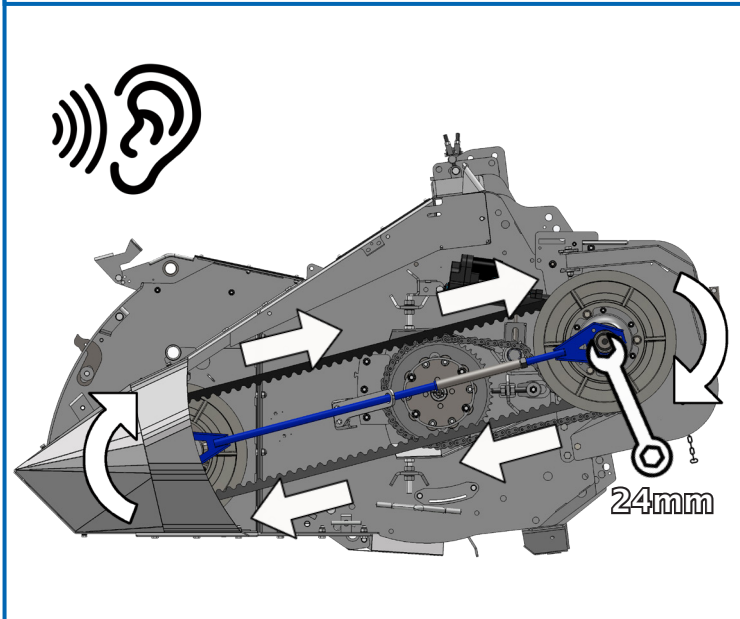

DO NOT touch belt or pulleys, use a wrench.

32. Check the front pulley gap is 61 mm. The rear pulley gap should be fully open and measure 86mm.

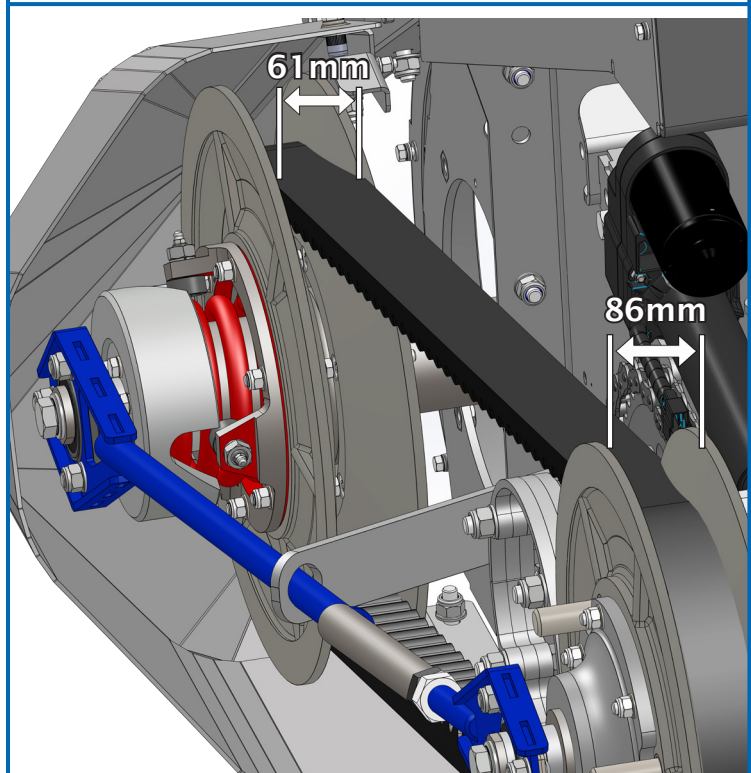

33. Pivot the gearbox if necessary.

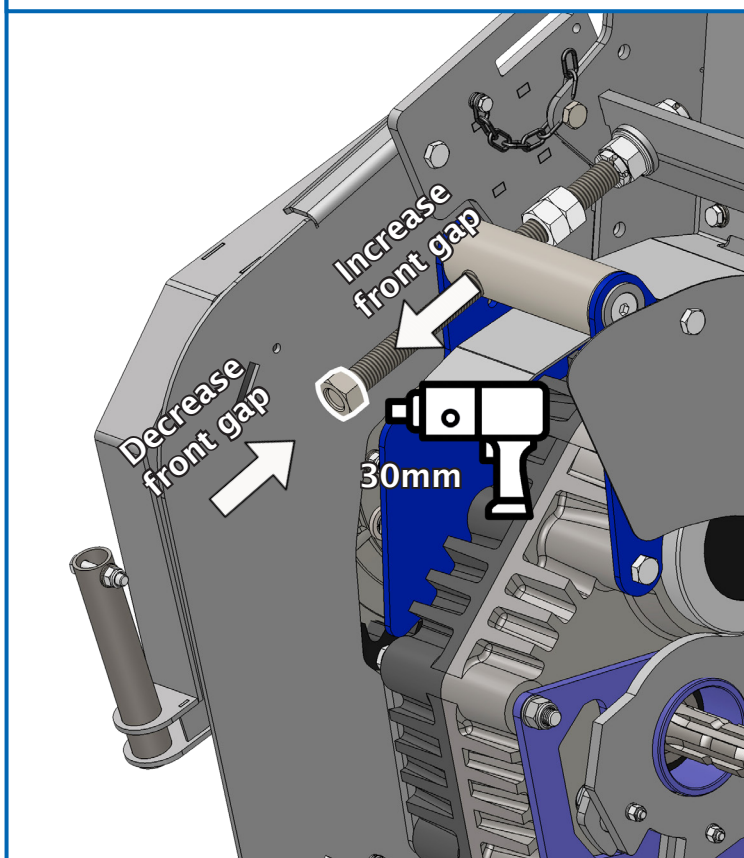

34. Turn over the drive by hand after adjusting the gearbox position. Rotate the drive system to allow the belt to re-settle in the pulleys.

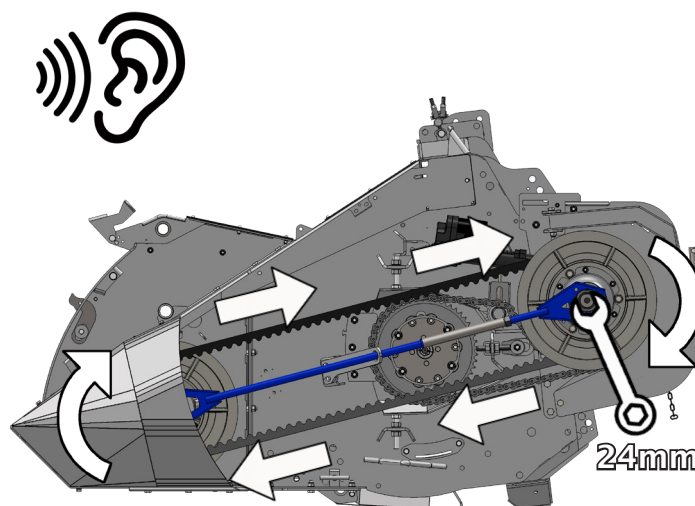

DO NOT touch belt or pulleys, use a wrench.

35. Refit the drive guard.

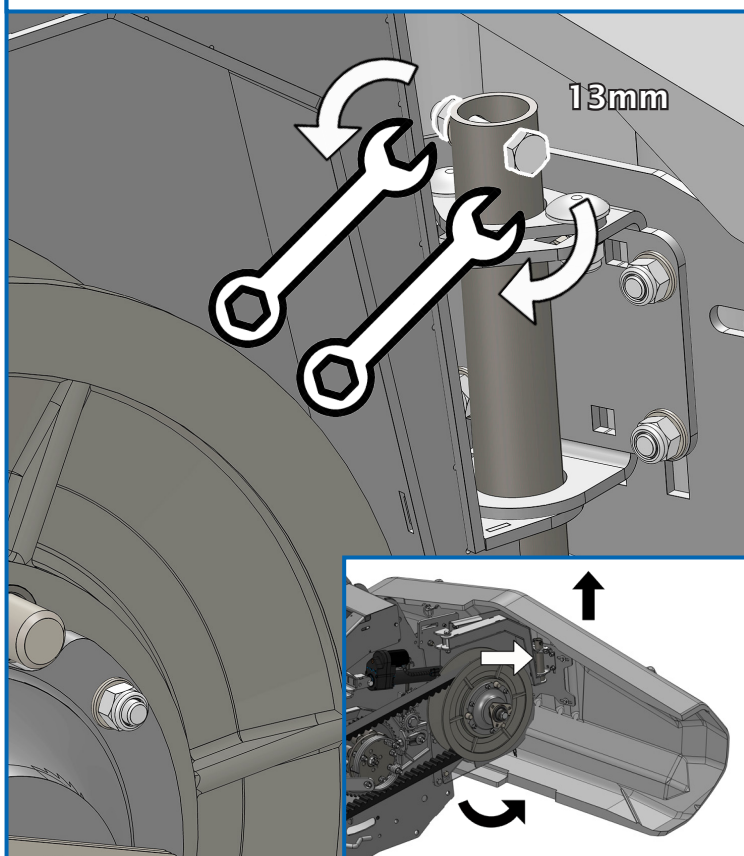

36. Run up the machine.

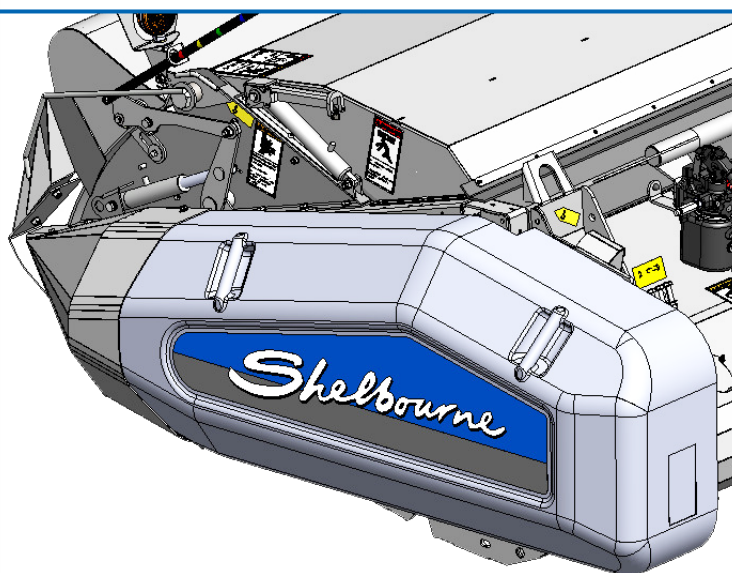

Make sure the guard is closed before running up.

Shelbourne Reynolds Engineering Limited

KIT-01463A				REAR PULLEY ASSY & ACTUATOR CAM KIT			
ITEM	PART NO	DESCRIPTION	QTY	ITEM	PART NO	DESCRIPTION	QTY
1	199350 01A	OUTER PULLEY HUB	1	25a	292710 01	FOLDED ACTUATOR BRKT	1
2	198270 01	OUTER REAR PULLEY	1	or		XCV 2012 AND ON (ALL YEARS) & CVS 2018 & ON (PRE-ASSEMBLED)	
3	SCEA08353	CSK SCREW	12	25b	292740 01	RH ACTUATOR BRKT (1 NOTCH)	1
4	WSH-0012	PLAIN WASHER	17			CVS & RVS 2001-2017	
5	NUT-0263	NYLOC NUT	17	26	WSH-0019	PLAIN WASHER	1
6	ORA300750	O RING	1	27	WSH-0018	PLAIN WASHER	1
7	198274 01	SPIGOT	3	28	BLTA12350	HEX HD BOLT	1
8	SCW-4528	GRUB SCREW	1	29	NUT-0270	NYLOC NUT	1
9	199410 01A	INNER PULLEY HUB	1	30	HSS-0150	SETSCREW	2
10	198271 01	INNER PULLEY	1	31	WSHA30161	LOCKWASHER	1
11	190119 11	WASHER	3	32	HSS-0316	SETSCREW	1
12	WSH-0061	SPRING WASHER	3				
13	HSS-0191	SETSCREW	3				
14	NIP-00620	GREASE NIPPLE	1				
15	BRG-19500NC3	BEARING	2				
16	292733 01	STATIC CAM	1				
17	291809 01	BUSH	3				
18	ORA120080	O RING	1				
19	HSS-0153	SETSCREW	3				
20	292736 01	CAM ARM SPACER	1				
21a	292737 01	BOLT ON STATIC CAM PLATE	1				
or		XCV 2012 AND ON (ALL YEARS) & CVS 2018 & ON (PRE-ASSEMBLED)					
21b	292739 01	BOLT ON STATIC CAM (1 NOTCH)	1				
or		CVS & RVS 2007-2017					
21c	292741 01	CVS & RVS 2001-2006, WITHOUT ROTOR GEARBOX	1				
		STATIC CAM PLATE (2 NOTCHES)					
		CVS & RVS 2001-2006, WITH ROTOR GEARBOX					
22	292704 01	ACTUATOR CAM W/A	1				
23	292695 01	BEARING BOSS	1				
24a	292709 01	ACTUATOR BRKT	1				
or		XCV 2012 AND ON (ALL YEARS) & CVS 2018 & ON (PRE-ASSEMBLED)					
24b	292740 02	RH ACTUATOR BRKT (1 NOTCH)	1				
		CVS & RVS 2001-2017					

TIPS TO ASSIST IDENTIFYING YOUR MACHINE MODEL AND YEAR:

XCV- SPRUNG, PIVOTING ADAPTOR PLATE WITH GAUGE WHEELS AT REAR OF HEADER.

CVS & RVS - BOLTED ADAPTOR PLATE, BRACING TUBE ACROSS TOP OF MACHINE.

LOCATE SERIAL NUMBER ON THE REAR LH OR RH END OF THE MACHINE.

7 DIGIT SERIAL NUMBERS 2000-2009

EXAMPLE '2122843'

1ST 2ND & 3RD DIGITS ARE FACOTRY BUILD NUMBERS, 4TH & 5TH IS THE SIZE OF MACHINE IN FEET (28'), 6TH DIGIT IS A FACTORY MACHINE TYPE NUMBER & 7TH DIGIT IS YEAR OF MANUFACTURE (2003).

11 DIGIT SERIAL NUMBERS 2010 AND ON

EXAMPLE 'XCV42198964'

1ST, 2ND & 3RD LETTERS SHOW THE TYPE OF MACHINE (XCV), 4TH & 5TH DIGITS SHOW THE MACHINE SIZE (42'), 6TH & 7TH DIGIT SHOW THE MODEL YEAR (2019), REMAINING DIGITS ARE FACTORY BUILD NUMBERS.

Shelbourne Reynolds Engineering Limited

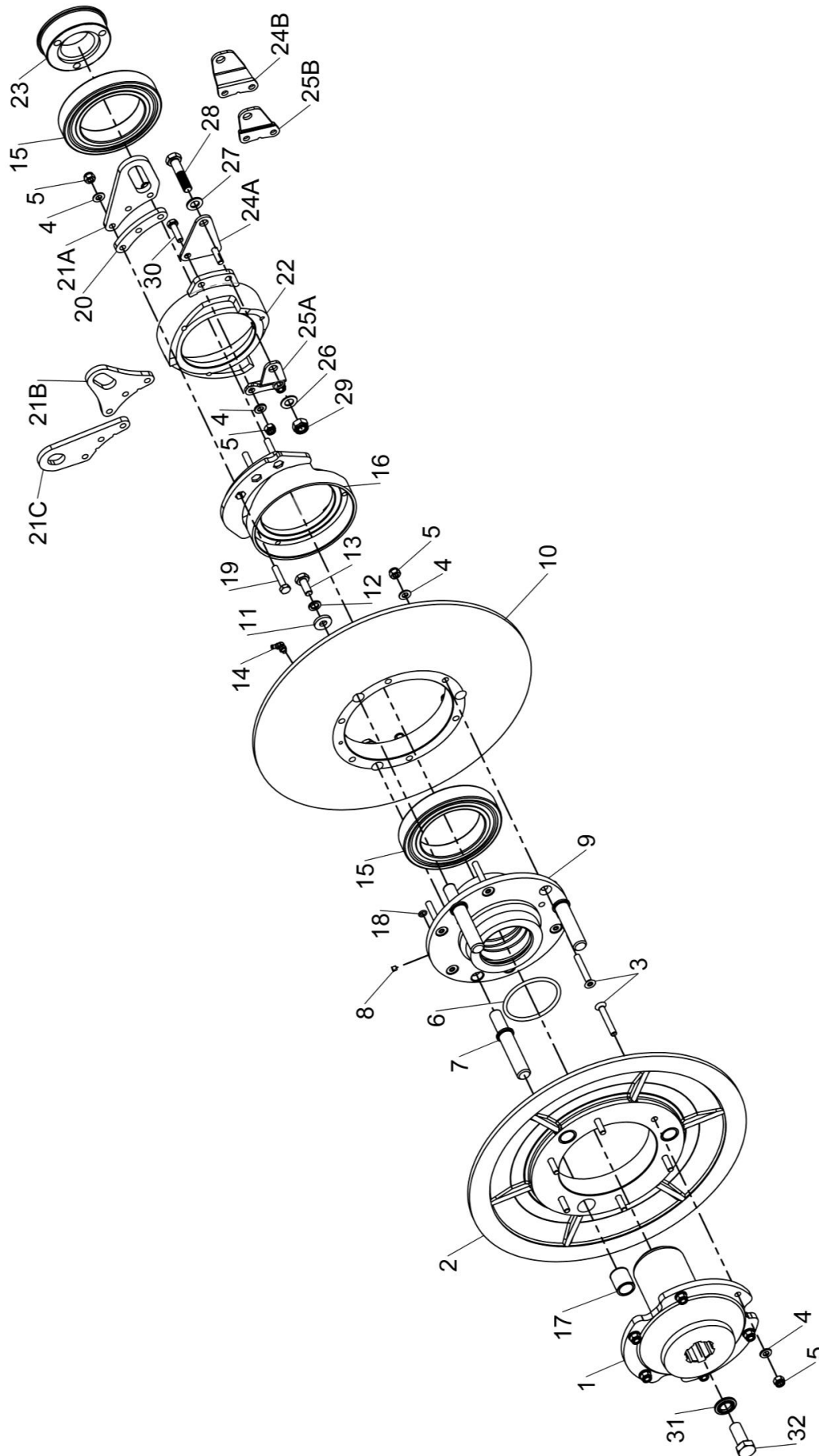

KIT-01463
KIT-01463A

