

KIT-01492 Fitting Instructions

Issue	Date	Changes
1	03/06/2025	Fitting Instructions Created



Safety Warning

These Fitting Instructions are for informational purposes only. Shelbourne Reynolds makes no representation or warranty, express or implied, regarding the information provided herein. Under no circumstances will Shelbourne Reynolds have any liability to you for any loss or damage resulting from the use of these instructions or reliance on any information provided. It is extremely dangerous to carry out any work on a machine while it is under power. Never remove or reattach any parts unless the machine is fully turned off and disengaged.

Please read all safety instructions contained in your operators manual and observe all safety signs attached to the Stripper header. Your use of these instructions is solely at your own risk.

Please use correct safety equipment at all times.



Refer to the Operators Manual for additional information and Safety procedures.

The Shelbourne Reynolds Multi-Functional Lever Mounted Switch Kit mounts to the multi-functional lever on John Deere X9 and S7 combines, already fitted with Shelbourne Reynolds Hydraulic Loom, (KIT-01737, KIT-01737B or KIT-01737C). The handle assembly buttons are then used to operate the Stripper Header crop deflector via the reel fore/aft solenoid valve, replacing the Shelbourne Reynolds in-cab console mounted rocker switch.

Recommended Tools List

Pliers
Cutter Pliers
T10 TORX Screw Driver Or
1/4" Ratchet With T10 TORX Bit

To view these
instructions online
please scan the
QR code.



1. Remove the wiring loom from the rocker switch.

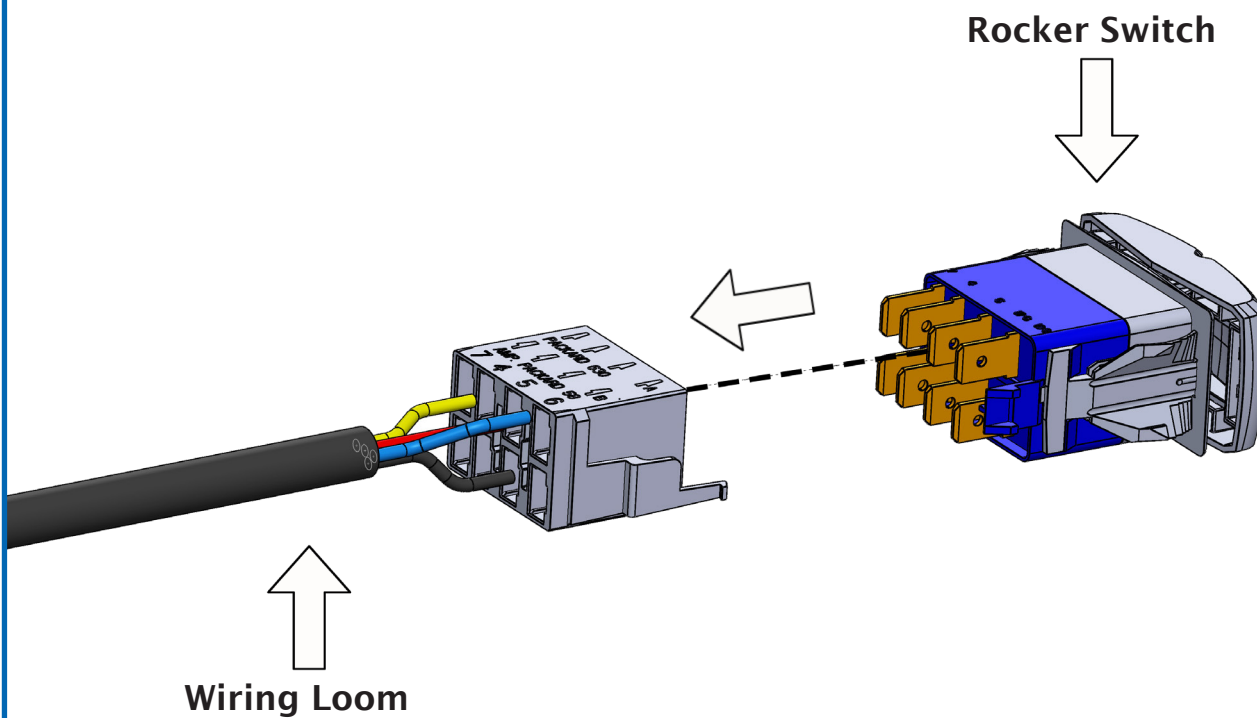

2. Snap off the tab on the quick release block if present, then fix the plug module to the

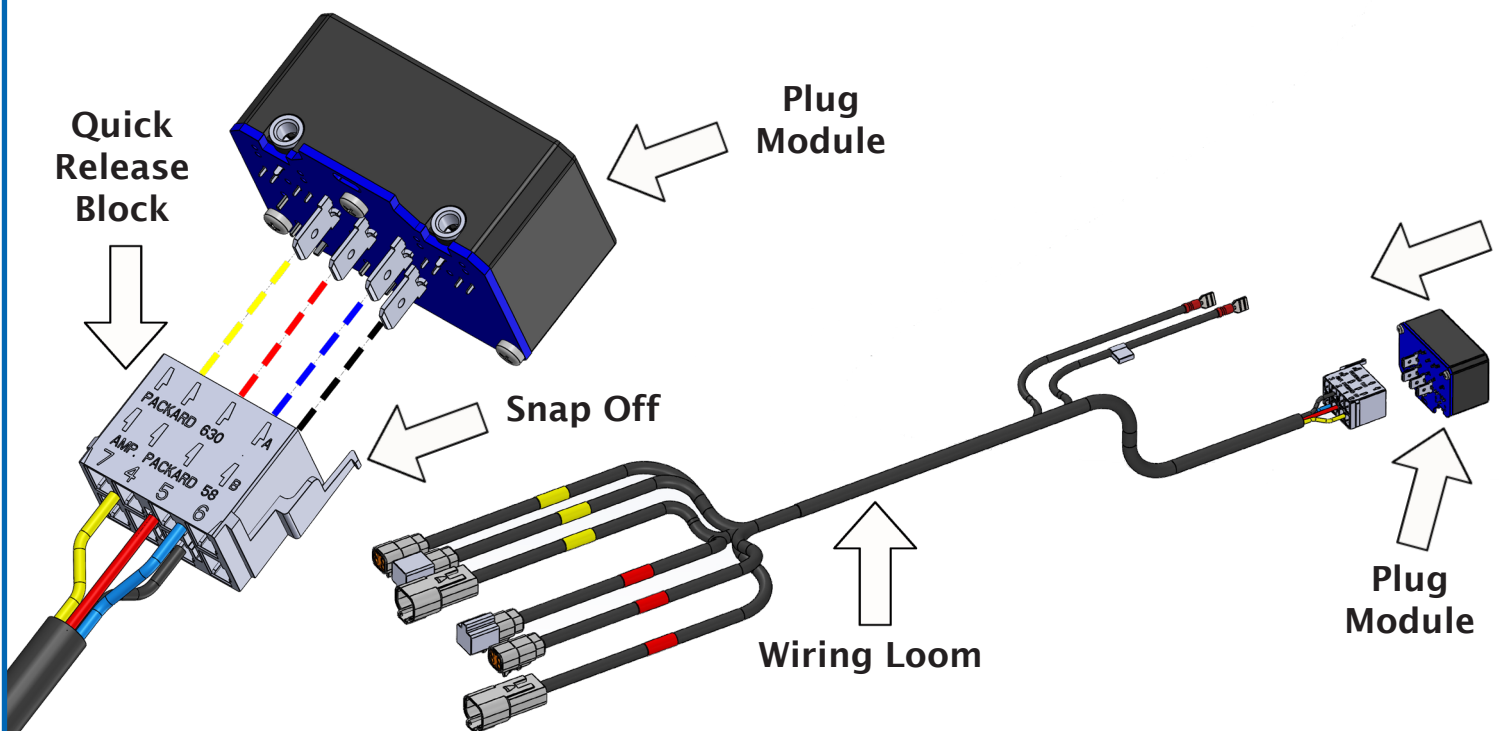

3. On older wiring looms there may not be an earth wire in cavity 3. You will need to connect an extra joystick ground wire as shown below, before fixing the plug module to the wiring loom, making sure the spade terminals are lined up.

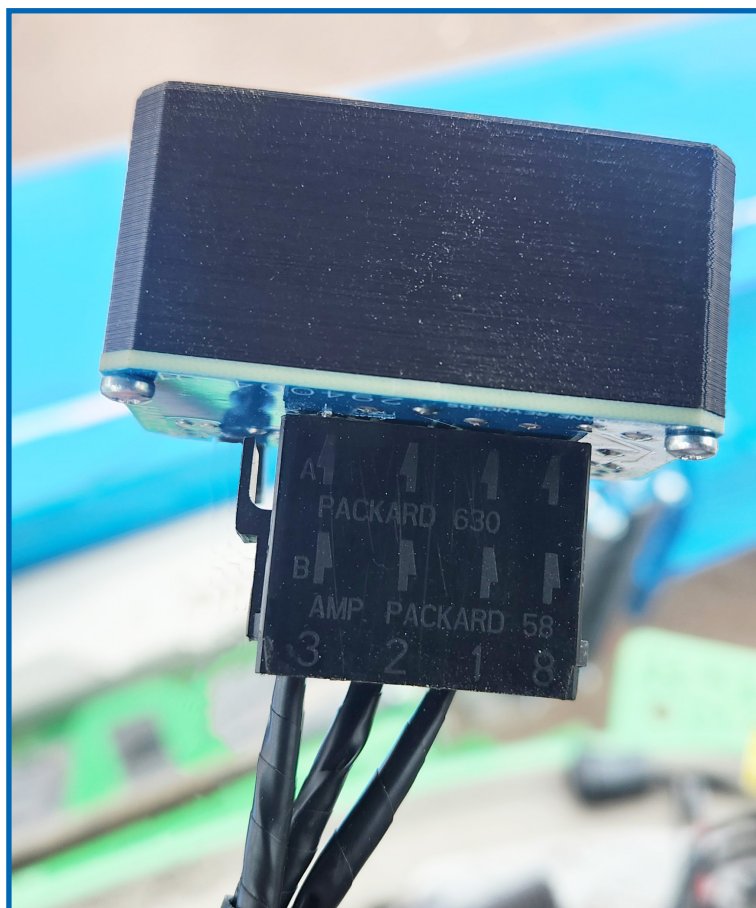
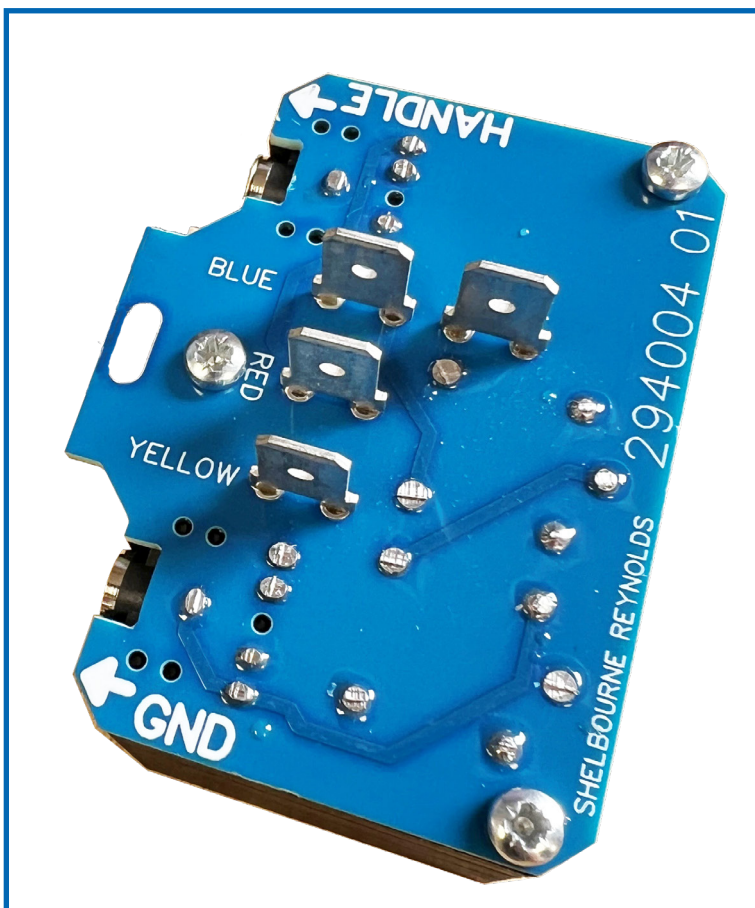
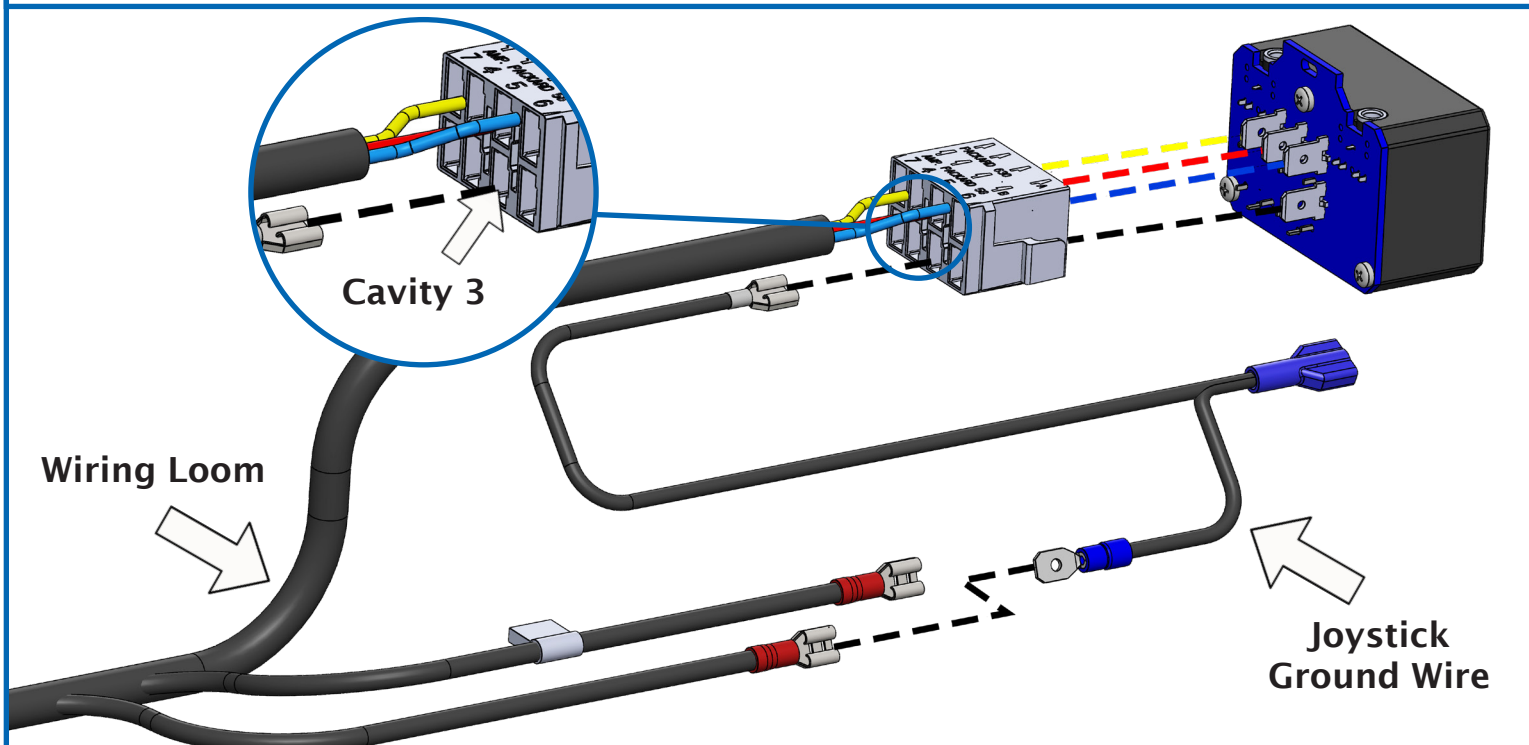

4. Use the self tapping screw to fix the handle assembly to the multi-function lever.

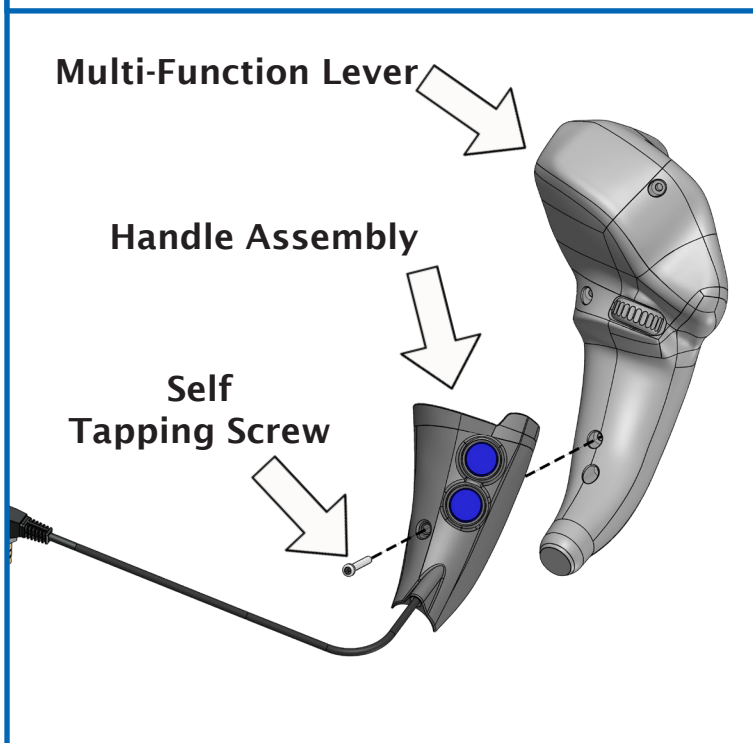

Tighten until there is no movement in the handle assembly but be careful not to overtighten.



5. Thread cable through rear of console.



6. Push the multi-function lever into the plug module making sure to use the correct jack port.

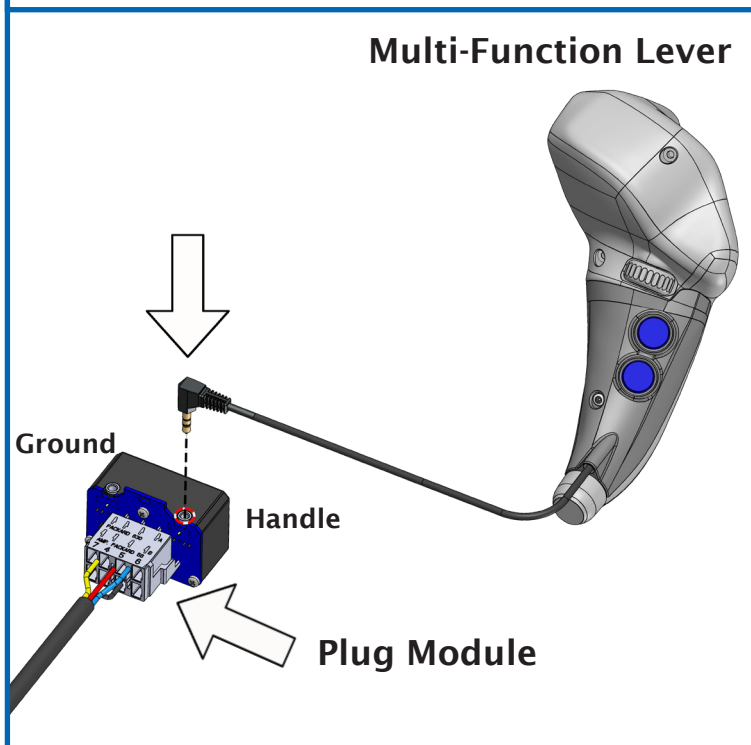

7. Cable tie the multi-function lever wire to the plug Module.



Shelbourne Reynolds Engineering Limited

KIT-01492					MULTI FUNCTIONAL LEVER MOUNTED SWITCH KIT		
ITEM	PART NO	DESCRIPTION	QTY	ITEM	PART NO	DESCRIPTION	QTY
1	294004 01	PLUG MODULE	1				
2	294009 01	HANDLE ASSEMBLY	1				
3	294272 01	JOYSTICK GROUND WIRE	1				
4	SCHS04206	SELF TAPPING SCREW	1				
5	TIE-0002	CABLE TIES (SMALL)	1				

Shelbourne Reynolds Engineering Limited

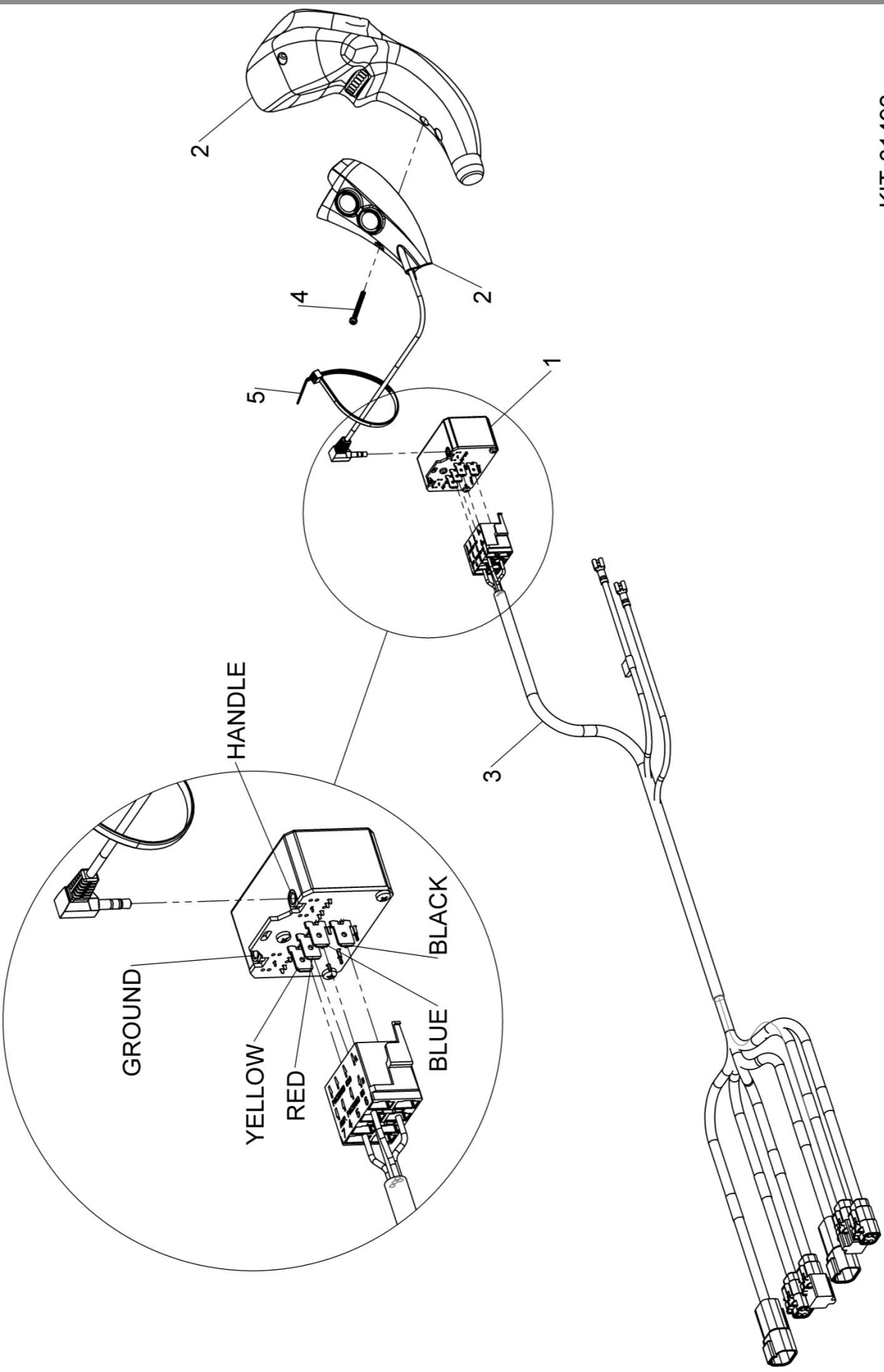

KIT-01492