

Rotor Panel Spare Part Number Changes

Issue	Date	Changes
1	07/07/2025	Technical parts bulletin created

Stripping rotor panel spare part numbers have changed recently. See on page 2 a list of the original spare panel part numbers and the new.

New and old panels can be mixed on a rotor assembly.

The new spare parts have various knock out holes and sections so they can be broken out to produce the exact style of panel that is being replaced.

They also have an additional end knock out section that will assist with cleaning out debris that could get into the end of the rotor assembly.

If this facility is wanted on pre 2025 headers, then break out both ends on 2 panels and fit panels on directly opposite faces of the rotor assembly.

Additional cover plates (Part no. 199753 01 x 4 / rotor) will also be required to cover the clean out holes.

Scan QR code to view technical parts bulletin online.

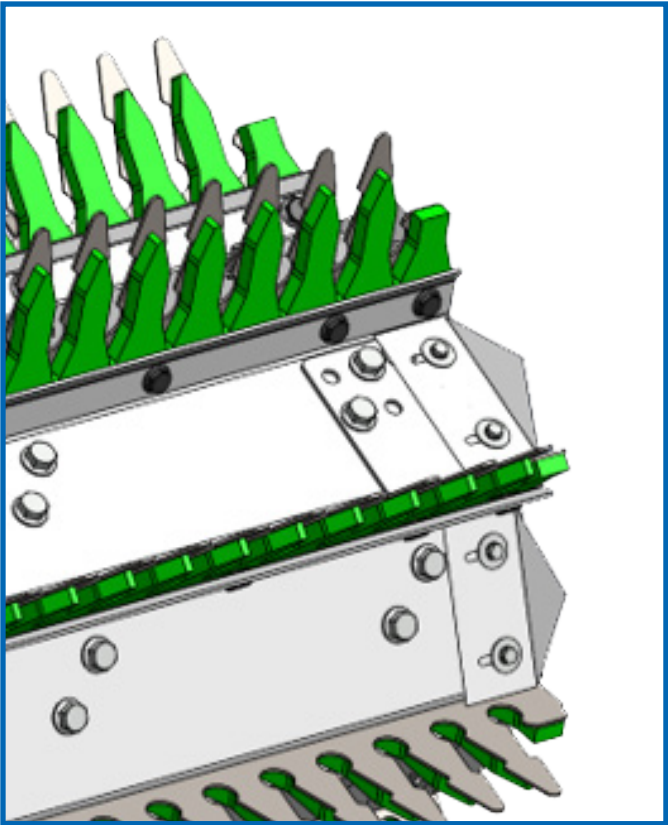
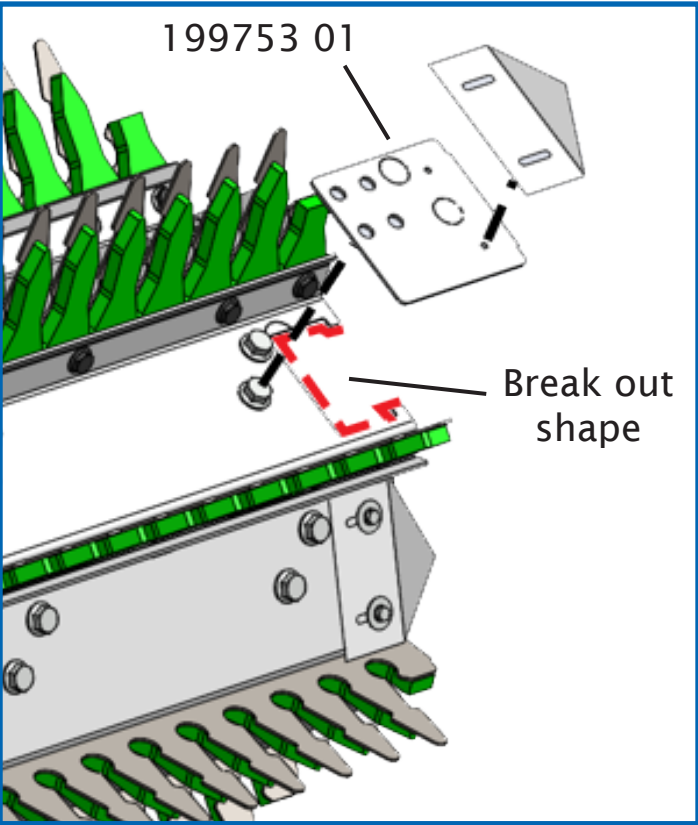

Rotor Panel Spare Part Number Changes

Header	Rotor	Original Part No	Description	New Part No	Length (approx.)	Qty
CVS20, CSD20, RSD20	LH	199620 04	Rotor Panel 3.0mm	293630 04	10'	8
	RH	199620 04	Rotor Panel 3.0mm	293630 04	10'	8
CVS24, CSD24, RSD24	LH	199019 04	Rotor Panel 3.6mm	293603 04	12'	8
	RH	199019 04	Rotor Panel 3.6mm	293603 04	12'	8
CVS28, CSD28, RSD28	LH	199111 04	Rotor Panel 4.2mm	293634 04	14'	8
	RH	199111 04	Rotor Panel 4.2mm	293634 04	14'	8
CVS32, CSD32, RSD32	LH	194370 01	Rotor Panel 4.2mm	293605 04	14'	4
	LH	194370 02	Rotor Panel 0.6mm	293606 04	2'	4
	LH	193527 01	Rotor Panel 4.2mm	293614 04	14'	4
	LH	193527 07	Rotor Panel 0.6mm	293606 06	2'	4
	RH	193526 01	Rotor Panel 4.2mm	293605 04	14'	4
	RH	193526 07	Rotor Panel 0.6mm	293606 04	2'	4
	RH	193527 01	Rotor Panel 4.2mm	293614 04	14'	4
	RH	193527 07	Rotor Panel 0.6mm	293606 06	2'	4
XCV32, XCS32, XRS32	LH	199620 04	Rotor Panel 3.0mm	293630 04	10'	8
	CTR	199019 04	Rotor Panel 3.6mm	293603 04	12'	8
	RH	199620 04	Rotor Panel 3.0mm	293630 04	10'	8
XCV36, XCS36, XRS36	LH	199019 04	Rotor Panel 3.6mm	293603 04	12'	8
	CTR	199019 04	Rotor Panel 3.6mm	293603 04	12'	8
	RH	199019 04	Rotor Panel 3.6mm	293603 04	12'	8
XCV42, XCS42, XRS42	LH	199111 04	Rotor Panel 4.2mm	293634 04	14'	8
	CTR	199111 04	Rotor Panel 4.2mm	293634 04	14'	8
	RH	199111 04	Rotor Panel 4.2mm	293634 04	14'	8